

## SUMMETH – Sustainable Marine Methanol

### Deliverable D4.1

### General arrangement, class documentation



**Date:** 2018-04-17

**Authors:** Joakim Bomanson, Bengt Ramne, ScandiNAOS

**Document Status:** Final

**Document Number:** D4.1

#### PROJECT PARTNERS



#### CO-FUNDED BY



Supported by the MARTEC II Network

## ABSTRACT

---

This report describes the design developed for converting the road ferry Jupiter to methanol operation. The conversion is based on existing regulations for low flashpoint fuels in combination with experience from other methanol conversions and conclusions from risk analysis and hazard identification studies. The reasoning behind the design choices is described along with the larger deviations from the requirements for SOLAS classed ships.

To convert Jupiter to methanol the aft diesel tank is modified to hold methanol and the surrounding tank room converted to a methanol storage area. The new compartment is equipped with mechanical ventilation, methanol vapour detection and has special procedures for safe operation. The four main engines are exchanged for methanol engines while the electrical generators and diesel boiler are kept on diesel. At a later stage the forward diesel tank can be modified and the remaining diesel consumers changed to methanol counterparts.

## SUMMETH PROJECT SUMMARY

---

SUMMETH, the **Sustainable Marine Methanol** project, is focused on developing clean methanol engine and fuel solutions for smaller ships. The project is advancing the development of methanol engines, fuel system installations, and distribution systems to facilitate the uptake of sustainable methanol as a fuel for coastal and inland waterway vessels through:

- developing, testing and evaluating different methanol combustion concepts for the smaller engine segment
- identifying the total greenhouse gas and emissions reduction potential of sustainable methanol through market investigations
- producing a case design for converting a road ferry to methanol operation
- assessing the requirements for transport and distribution of sustainable methanol.

The SUMMETH project consortium consists of SSPA Sweden, ScandiNAOS, Lund University, VTT Technical Research Centre of Finland, Scania AB, Marine Benchmark, Swedish Transport Administration Road Ferries, and the Swedish Maritime Technology Forum.

## ACKNOWLEDGEMENTS

---

The SUMMETH project is supported by the MARTEC II network and co-funded by the Swedish Maritime Administration, Region Västra Götaland, the Methanol Institute and Oiltanking Finland Oy.

## Document Data

Document Title:	D4.1 General arrangement, class documentation
WP and/or Task:	WP4
Responsible Author:	Joakim Bomanson
Co-authors	Bengt Ramne, Patrik Molander
Date and Version:	2018-04-17 Final
Previous Versions:	2017-12-08 Draft 1

# TABLE OF CONTENTS

---

Abstract .....	ii
SUMMETH Project Summary.....	ii
Acknowledgements .....	ii
1 Introduction.....	1
1.1 Abbreviations .....	1
1.2 Design philosophy and regulatory framework.....	4
1.3 About methanol .....	1
2 Conversion details .....	4
2.1 General functionality and principles of the methanol system .....	6
2.2 Methanol tank room .....	6
2.3 Methanol tank.....	7
2.3.1 Tank inertion .....	8
2.3.2 Tank Ventilation .....	10
2.3.3 Bunker connection .....	11
2.4 Fuel system.....	12
2.5 Machinery Room and Engines.....	13
2.6 Vapour detection.....	14
2.7 Fire detection .....	14
2.8 Fire suppression .....	15
2.8.1 Deck wash system .....	15
2.9 Hazardous area plan.....	16
2.10 Major design alternatives.....	17
2.10.1 Alternative to tank inertion.....	17
2.10.2 Methanol tank bladder.....	18
3 Discussion and Conclusions.....	19
4 References.....	20
Appendix I – Safety Data Sheets.....	21
Appendix II - SNP15095-100 General Arrangement Methanol Conversion.....	23
Appendix III - SNP15095-707 Hazardous area plan.....	24
Appendix IV - SNP15095-780 System Coordination Diagram .....	25

# 1 INTRODUCTION

---

Methanol has a long history of being used as a fuel and during recent years has been identified as a possible future fuel for the marine industry. Development of rules and standards as well as practical experience of how to handle the liquid on board is still ongoing. Methanol is not unknown to the sea transport sector, however, as it is one of the world's most transported commodities and there is much experience with handling methanol both at sea and in port.

For use of conventional diesel fuels on board the requirements are for all intents and purposes pretty clear. Where written regulations don't dictate the design, praxis does. For methanol as a marine fuel experience is scarce and the chemical properties motivate some practical changes. Special considerations are necessary to achieve a corresponding level of safety. Rules partly exist but not for smaller ships such as a road ferry. Based on the existing rules and experience a design for conversion of the road ferry Jupiter to methanol operation has been developed and is presented in this report. While the design was done specifically for the Jupiter, similar solutions are reasonable for other ships of the same type.

## 1.1 ABBREVIATIONS

IBC Code	International Code for the Construction and Equipment of Ships carrying Dangerous Chemicals in Bulk
IGF Code	International Code of Safety for Ships Using Gases or Other Low-Flashpoint Fuels
IMO	International Maritime Organisation
LEL	Lower Explosion Limit
LFL	Low Flashpoint Fuels
SOLAS	International Convention for the Safety of Life at Sea
TS	Swedish Transport Agency

## 1.2 ABOUT METHANOL

Methanol is the simplest alcohol, having one carbon atom and the chemical formula  $\text{CH}_3\text{OH}$ . It is used as a building block in all sorts of chemical industries and is one of the most transported commodities on earth. Most of the methanol available on the market is produced from natural gas but any carbon source can be used. Methanol can be used as chemical energy storage when it is created as an electro fuel. Hydrogen from electrolysis of water is combined with carbon dioxide to form methanol, which is easier to store and transport and has higher energy density compared to compressed hydrogen or batteries. The large quantity of methanol already available in combination with the relative ease of sustainable production is one major advantage of methanol.

From a safety perspective methanol offers some new challenges. In contrast to diesel fuels the flashpoint is low which means that methanol is easily ignited by a spark or open flame. The low flashpoint is the largest difference in terms of safety and as a result all equipment used where methanol leaks can be expected needs to be of explosion proof type (EX-class).

As methanol is a liquid, conventional fuel tanks are used for storage. As a liquid potential spills will also behave like a liquid and conventional fire suppression methods are used. Methanol is also soluble in water and water can be used to put out methanol fires.

### 1.2.1 Fire

By using the flashpoint, vapour pressure and flammability range a corresponding temperature where a flammable atmosphere can occur inside a closed tank can be calculated. The table below illustrates that for methanol a combustible mixture can form inside a closed tank in the temperature range between 11 and 41°C. This is a reason why tank inertion is required by the IGF code when using methanol. The image below also shows the heat radiation from pool fires of 50 m<sup>2</sup> and 4 m<sup>2</sup> respectively for pure methanol and a gasoline-methanol mixture. The heat radiation from the pure methanol fire is significantly less which makes a potential fire easier to approach for firefighting.

	Vapor pressure @20°C [kPa]	Flamability range [vol%]	Flashpoint [°C]	Translated temperature range [°C]
Methanol	12.3	6 – 36	11	11 – 41
Diesel	0.05	1 – 6	>56	60 – 150
Gasoline	40 – 100	1.4 – 7.6	<-40	-43 – 10

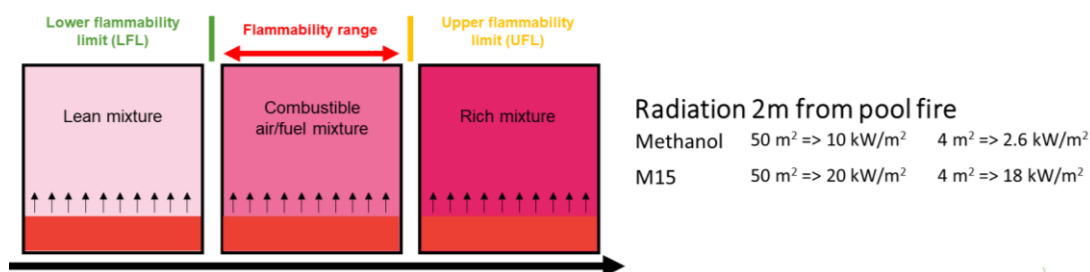

Figure 1: Flammability and fire characteristics summary of methanol compared to diesel and gasoline. Numbers and figures adopted from SP Rapport 2017:22 proFLASH: Methanol fire detection and extinguishment.

### 1.2.2 Toxicity

As methanol is toxic precautions during handling are necessary. During work with methanol equipment eye protection should be used and exposure to the skin avoided. If ingested, seek immediate medical attention. Compared to diesel and gasoline methanol is more toxic (classified as toxic in contrast to harmful) but is not carcinogenic. It is also classified as highly flammable in contrast to flammable (diesel) and extremely flammable (gasoline).

From an environmental perspective methanol is soluble in water and quickly biodegrades with no lasting effects on the environment. As a result methanol can, in contrast to petroleum products, be stored in double bottom tanks without double barrier towards the sea.











	METHANOL	DIESEL	GASOLINE
Hazard pictograms (CPL)	  	   	  
Signal word: (CPL)	Danger	Danger	Danger
Hazard statements (CPL)	H228 Highly flammable liquid and vapour. H302: Toxic if swallowed. H311: Toxic in contact with skin. H331: Toxic if inhaled. H370 Causes damage to organs.	H228: Flammable liquid and vapour. H304: May be fatal if swallowed and enters airways. H311: Toxic if swallowed. H331: Toxic if inhaled. H332: Irritant if inhaled. H334: Suspected of causing cancer. H370: May cause damage to organs through prolonged or repeated exposure. H411: Toxic to aquatic life with long lasting effects.	H224: Extremely flammable liquid and vapour. H304: May be fatal if swallowed and enters airways H311: Toxic if swallowed H331: Toxic if inhaled H332: May cause genetic effects H334: May cause cancer H360: Suspected of damaging fertility or the unborn child H370: May cause drowsiness or dizziness H411: Toxic to aquatic life with long lasting effects
Precautionary statements (CLP)	P201: Keep away from heat. No smoking. P202: Wear protective gloves, protective clothing, eye protection, face protection P240: P240: Remove victim to fresh air and keep at rest in a position comfortable for breathing P241: P241: Do not breathe fumes (vapour) dust of immediately after contamination clothing. Remove skin with water/Showers P271: P271: Do not swallow. Do not eat or drink or smoke when using this product P280: P280: Wear protective gloves/long sleeves/face protection P281: P281: Wash face thoroughly after handling P282: P282: Do not eat, drink or smoke when using this product P283: P283: Avoid release to the environment P284: P284: Wear protective gloves/long sleeves/face protection P285: P285: If swallowed: Immediately call a POISON CENTRE or doctor P286: P286: Wash with plenty of water P287: P287: In case of skin contact: Wash with plenty of water P288: P288: In case of eye contact: Flush immediately with copious amounts of water P289: P289: Remove victim to fresh air and keep at rest in a position comfortable for breathing P290: P290: Irritant to eyes, skin and clothing. Get medical advice/attention P291: P291: Do not breathe fumes (vapour) dust of immediately after contamination clothing. Remove skin with water/Showers P292: P292: Do not swallow. Do not eat or drink or smoke when using this product P293: P293: Do not breathe fumes (vapour) dust of immediately after contamination clothing. Remove skin with water/Showers P294: P294: Wash face thoroughly after handling P295: P295: Do not eat, drink or smoke when using this product P296: P296: Avoid release to the environment P297: P297: Do not breathe fumes (vapour) dust of immediately after contamination clothing. Remove skin with water/Showers P298: P298: In case of eye contact: Flush immediately with copious amounts of water P299: P299: Remove victim to fresh air and keep at rest in a position comfortable for breathing P300: P300: In case of skin contact: Wash with plenty of water P301: P301: In case of eye contact: Flush immediately with copious amounts of water P302: P302: In case of eye contact: Flush immediately with copious amounts of water P303: P303: In case of eye contact: Flush immediately with copious amounts of water P304: P304: In case of eye contact: Flush immediately with copious amounts of water P305: P305: In case of eye contact: Flush immediately with copious amounts of water P306: P306: In case of eye contact: Flush immediately with copious amounts of water P307: P307: In case of eye contact: Flush immediately with copious amounts of water P308: P308: In case of eye contact: Flush immediately with copious amounts of water P309: P309: In case of eye contact: Flush immediately with copious amounts of water P310: P310: In case of eye contact: Flush immediately with copious amounts of water P311: P311: In case of eye contact: Flush immediately with copious amounts of water P312: P312: In case of eye contact: Flush immediately with copious amounts of water P313: P313: In case of eye contact: Flush immediately with copious amounts of water P314: P314: In case of eye contact: Flush immediately with copious amounts of water P315: P315: In case of eye contact: Flush immediately with copious amounts of water P316: P316: In case of eye contact: Flush immediately with copious amounts of water P317: P317: In case of eye contact: Flush immediately with copious amounts of water P318: P318: In case of eye contact: Flush immediately with copious amounts of water P319: P319: In case of eye contact: Flush immediately with copious amounts of water P320: P320: In case of eye contact: Flush immediately with copious amounts of water P321: P321: In case of eye contact: Flush immediately with copious amounts of water P322: P322: In case of eye contact: Flush immediately with copious amounts of water P323: P323: In case of eye contact: Flush immediately with copious amounts of water P324: P324: In case of eye contact: Flush immediately with copious amounts of water P325: P325: In case of eye contact: Flush immediately with copious amounts of water P326: P326: In case of eye contact: Flush immediately with copious amounts of water P327: P327: In case of eye contact: Flush immediately with copious amounts of water P328: P328: In case of eye contact: Flush immediately with copious amounts of water P329: P329: In case of eye contact: Flush immediately with copious amounts of water P330: P330: In case of eye contact: Flush immediately with copious amounts of water P331: P331: In case of eye contact: Flush immediately with copious amounts of water P332: P332: In case of eye contact: Flush immediately with copious amounts of water P333: P333: In case of eye contact: Flush immediately with copious amounts of water P334: P334: In case of eye contact: Flush immediately with copious amounts of water P335: P335: In case of eye contact: Flush immediately with copious amounts of water P336: P336: In case of eye contact: Flush immediately with copious amounts of water P337: P337: In case of eye contact: Flush immediately with copious amounts of water P338: P338: In case of eye contact: Flush immediately with copious amounts of water P339: P339: In case of eye contact: Flush immediately with copious amounts of water P340: P340: In case of eye contact: Flush immediately with copious amounts of water P341: P341: In case of eye contact: Flush immediately with copious amounts of water P342: P342: In case of eye contact: Flush immediately with copious amounts of water P343: P343: In case of eye contact: Flush immediately with copious amounts of water P344: P344: In case of eye contact: Flush immediately with copious amounts of water P345: P345: In case of eye contact: Flush immediately with copious amounts of water P346: P346: In case of eye contact: Flush immediately with copious amounts of water P347: P347: In case of eye contact: Flush immediately with copious amounts of water P348: P348: In case of eye contact: Flush immediately with copious amounts of water P349: P349: In case of eye contact: Flush immediately with copious amounts of water P350: P350: In case of eye contact: Flush immediately with copious amounts of water P351: P351: In case of eye contact: Flush immediately with copious amounts of water P352: P352: In case of eye contact: Flush immediately with copious amounts of water P353: P353: In case of eye contact: Flush immediately with copious amounts of water P354: P354: In case of eye contact: Flush immediately with copious amounts of water P355: P355: In case of eye contact: Flush immediately with copious amounts of water P356: P356: In case of eye contact: Flush immediately with copious amounts of water P357: P357: In case of eye contact: Flush immediately with copious amounts of water P358: P358: In case of eye contact: Flush immediately with copious amounts of water P359: P359: In case of eye contact: Flush immediately with copious amounts of water P360: P360: In case of eye contact: Flush immediately with copious amounts of water P361: P361: In case of eye contact: Flush immediately with copious amounts of water P362: P362: In case of eye contact: Flush immediately with copious amounts of water P363: P363: In case of eye contact: Flush immediately with copious amounts of water P364: P364: In case of eye contact: Flush immediately with copious amounts of water P365: P365: In case of eye contact: Flush immediately with copious amounts of water P366: P366: In case of eye contact: Flush immediately with copious amounts of water P367: P367: In case of eye contact: Flush immediately with copious amounts of water P368: P368: In case of eye contact: Flush immediately with copious amounts of water P369: P369: In case of eye contact: Flush immediately with copious amounts of water P370: P370: In case of eye contact: Flush immediately with copious amounts of water P371: P371: In case of eye contact: Flush immediately with copious amounts of water P372: P372: In case of eye contact: Flush immediately with copious amounts of water P373: P373: In case of eye contact: Flush immediately with copious amounts of water P374: P374: In case of eye contact: Flush immediately with copious amounts of water P375: P375: In case of eye contact: Flush immediately with copious amounts of water P376: P376: In case of eye contact: Flush immediately with copious amounts of water P377: P377: In case of eye contact: Flush immediately with copious amounts of water P378: P378: In case of eye contact: Flush immediately with copious amounts of water P379: P379: In case of eye contact: Flush immediately with copious amounts of water P380: P380: In case of eye contact: Flush immediately with copious amounts of water P381: P381: In case of eye contact: Flush immediately with copious amounts of water P382: P382: In case of eye contact: Flush immediately with copious amounts of water P383: P383: In case of eye contact: Flush immediately with copious amounts of water P384: P384: In case of eye contact: Flush immediately with copious amounts of water P385: P385: In case of eye contact: Flush immediately with copious amounts of water P386: P386: In case of eye contact: Flush immediately with copious amounts of water P387: P387: In case of eye contact: Flush immediately with copious amounts of water P388: P388: In case of eye contact: Flush immediately with copious amounts of water P389: P389: In case of eye contact: Flush immediately with copious amounts of water P390: P390: In case of eye contact: Flush immediately with copious amounts of water P391: P391: In case of eye contact: Flush immediately with copious amounts of water P392: P392: In case of eye contact: Flush immediately with copious amounts of water P393: P393: In case of eye contact: Flush immediately with copious amounts of water P394: P394: In case of eye contact: Flush immediately with copious amounts of water P395: P395: In case of eye contact: Flush immediately with copious amounts of water P396: P396: In case of eye contact: Flush immediately with copious amounts of water P397: P397: In case of eye contact: Flush immediately with copious amounts of water P398: P398: In case of eye contact: Flush immediately with copious amounts of water P399: P399: In case of eye contact: Flush immediately with copious amounts of water P400: P400: In case of eye contact: Flush immediately with copious amounts of water P401: P401: In case of eye contact: Flush immediately with copious amounts of water P402: P402: In case of eye contact: Flush immediately with copious amounts of water P403: P403: In case of eye contact: Flush immediately with copious amounts of water P404: P404: In case of eye contact: Flush immediately with copious amounts of water P405: P405: In case of eye contact: Flush immediately with copious amounts of water P406: P406: In case of eye contact: Flush immediately with copious amounts of water P407: P407: In case of eye contact: Flush immediately with copious amounts of water P408: P408: In case of eye contact: Flush immediately with copious amounts of water P409: P409: In case of eye contact: Flush immediately with copious amounts of water P410: P410: In case of eye contact: Flush immediately with copious amounts of water P411: P411: In case of eye contact: Flush immediately with copious amounts of water P412: P412: In case of eye contact: Flush immediately with copious amounts of water P413: P413: In case of eye contact: Flush immediately with copious amounts of water P414: P414: In case of eye contact: Flush immediately with copious amounts of water P415: P415: In case of eye contact: Flush immediately with copious amounts of water P416: P416: In case of eye contact: Flush immediately with copious amounts of water P417: P417: In case of eye contact: Flush immediately with copious amounts of water P418: P418: In case of eye contact: Flush immediately with copious amounts of water P419: P419: In case of eye contact: Flush immediately with copious amounts of water P420: P420: In case of eye contact: Flush immediately with copious amounts of water P421: P421: In case of eye contact: Flush immediately with copious amounts of water P422: P422: In case of eye contact: Flush immediately with copious amounts of water P423: P423: In case of eye contact: Flush immediately with copious amounts of water P424: P424: In case of eye contact: Flush immediately with copious amounts of water P425: P425: In case of eye contact: Flush immediately with copious amounts of water P426: P426: In case of eye contact: Flush immediately with copious amounts of water P427: P427: In case of eye contact: Flush immediately with copious amounts of water P428: P428: In case of eye contact: Flush immediately with copious amounts of water P429: P429: In case of eye contact: Flush immediately with copious amounts of water P430: P430: In case of eye contact: Flush immediately with copious amounts of water P431: P431: In case of eye contact: Flush immediately with copious amounts of water P432: P432: In case of eye contact: Flush immediately with copious amounts of water P433: P433: In case of eye contact: Flush immediately with copious amounts of water P434: P434: In case of eye contact: Flush immediately with copious amounts of water P435: P435: In case of eye contact: Flush immediately with copious amounts of water P436: P436: In case of eye contact: Flush immediately with copious amounts of water P437: P437: In case of eye contact: Flush immediately with copious amounts of water P438: P438: In case of eye contact: Flush immediately with copious amounts of water P439: P439: In case of eye contact: Flush immediately with copious amounts of water P440: P440: In case of eye contact: Flush immediately with copious amounts of water P441: P441: In case of eye contact: Flush immediately with copious amounts of water P442: P442: In case of eye contact: Flush immediately with copious amounts of water P443: P443: In case of eye contact: Flush immediately with copious amounts of water P444: P444: In case of eye contact: Flush immediately with copious amounts of water P445: P445: In case of eye contact: Flush immediately with copious amounts of water P446: P446: In case of eye contact: Flush immediately with copious amounts of water P447: P447: In case of eye contact: Flush immediately with copious amounts of water P448: P448: In case of eye contact: Flush immediately with copious amounts of water P449: P449: In case of eye contact: Flush immediately with copious amounts of water P450: P450: In case of eye contact: Flush immediately with copious amounts of water P451: P451: In case of eye contact: Flush immediately with copious amounts of water P452: P452: In case of eye contact: Flush immediately with copious amounts of water P453: P453: In case of eye contact: Flush immediately with copious amounts of water P454: P454: In case of eye contact: Flush immediately with copious amounts of water P455: P455: In case of eye contact: Flush immediately with copious amounts of water P456: P456: In case of eye contact: Flush immediately with copious amounts of water P457: P457: In case of eye contact: Flush immediately with copious amounts of water P458: P458: In case of eye contact: Flush immediately with copious amounts of water P459: P459: In case of eye contact: Flush immediately with copious amounts of water P460: P460: In case of eye contact: Flush immediately with copious amounts of water P461: P461: In case of eye contact: Flush immediately with copious amounts of water P462: P462: In case of eye contact: Flush immediately with copious amounts of water P463: P463: In case of eye contact: Flush immediately with copious amounts of water P464: P464: In case of eye contact: Flush immediately with copious amounts of water P465: P465: In case of eye contact: Flush immediately with copious amounts of water P466: P466: In case of eye contact: Flush immediately with copious amounts of water P467: P467: In case of eye contact: Flush immediately with copious amounts of water P468: P468: In case of eye contact: Flush immediately with copious amounts of water P469: P469: In case of eye contact: Flush immediately with copious amounts of water P470: P470: In case of eye contact: Flush immediately with copious amounts of water P471: P471: In case of eye contact: Flush immediately with copious amounts of water P472: P472: In case of eye contact: Flush immediately with copious amounts of water P473: P473: In case of eye contact: Flush immediately with copious amounts of water P474: P474: In case of eye contact: Flush immediately with copious amounts of water P475: P475: In case of eye contact: Flush immediately with copious amounts of water P476: P476: In case of eye contact: Flush immediately with copious amounts of water P477: P477: In case of eye contact: Flush immediately with copious amounts of water P478: P478: In case of eye contact: Flush immediately with copious amounts of water P479: P479: In case of eye contact: Flush immediately with copious amounts of water P480: P480: In case of eye contact: Flush immediately with copious amounts of water P481: P481: In case of eye contact: Flush immediately with copious amounts of water P482: P482: In case of eye contact: Flush immediately with copious amounts of water P483: P483: In case of eye contact: Flush immediately with copious amounts of water P484: P484: In case of eye contact: Flush immediately with copious amounts of water P485: P485: In case of eye contact: Flush immediately with copious amounts of water P486: P486: In case of eye contact: Flush immediately with copious amounts of water P487: P487: In case of eye contact: Flush immediately with copious amounts of water P488: P488: In case of eye contact: Flush immediately with copious amounts of water P489: P489: In case of eye contact: Flush immediately with copious amounts of water P490: P490: In case of eye contact: Flush immediately with copious amounts of water P491: P491: In case of eye contact: Flush immediately with copious amounts of water P492: P492: In case of eye contact: Flush immediately with copious amounts of water P493: P493: In case of eye contact: Flush immediately with copious amounts of water P494: P494: In case of eye contact: Flush immediately with copious amounts of water P495: P495: In case of eye contact: Flush immediately with copious amounts of water P496: P496: In case of eye contact: Flush immediately with copious amounts of water P497: P497: In case of eye contact: Flush immediately with copious amounts of water P498: P498: In case of eye contact: Flush immediately with copious amounts of water P499: P499: In case of eye contact: Flush immediately with copious amounts of water P500: P500: In case of eye contact: Flush immediately with copious amounts of water P501: P501: In case of eye contact: Flush immediately with copious amounts of water P502: P502: In case of eye contact: Flush immediately with copious amounts of water P503: P503: In case of eye contact: Flush immediately with copious amounts of water P504: P504: In case of eye contact: Flush immediately with copious amounts of water P505: P505: In case of eye contact: Flush immediately with copious amounts of water P506: P506: In case of eye contact: Flush immediately with copious amounts of water P507: P507: In case of eye contact: Flush immediately with copious amounts of water P508: P508: In case of eye contact: Flush immediately with copious amounts of water P509: P509: In case of eye contact: Flush immediately with copious amounts of water P510: P510: In case of eye contact: Flush immediately with copious amounts of water P511: P511: In case of eye contact: Flush immediately with copious amounts of water P512: P512: In case of eye contact: Flush immediately with copious amounts of water P513: P513: In case of eye contact: Flush immediately with copious amounts of water P514: P514: In case of eye contact: Flush immediately with copious amounts of water P515: P515: In case of eye contact: Flush immediately with copious amounts of water P516: P516: In case of eye contact: Flush immediately with copious amounts of water P517: P517: In case of eye contact: Flush immediately with copious amounts of water P518: P518: In case of eye contact: Flush immediately with copious amounts of water P519: P519: In case of eye contact: Flush immediately with copious amounts of water P520: P520: In case of eye contact: Flush immediately with copious amounts of water P521: P521: In case of eye contact: Flush immediately with copious amounts of water P522: P522: In case of eye contact: Flush immediately with copious amounts of water P523: P523: In case of eye contact: Flush immediately with copious amounts of water P524: P524: In case of eye contact: Flush immediately with copious amounts of water P525: P525: In case of eye contact: Flush immediately with copious amounts of water P526: P526: In case of eye contact: Flush immediately with copious amounts of water P527: P527: In case of eye contact: Flush immediately with copious amounts of water P528: P528: In case of eye contact: Flush immediately with copious amounts of water P529: P529: In case of eye contact: Flush immediately with copious amounts of water P530: P530: In case of eye contact: Flush immediately with copious amounts of water P531: P531: In case of eye contact: Flush immediately with copious amounts of water P532: P532: In case of eye contact: Flush immediately with copious amounts of water P533: P533: In case of eye contact: Flush immediately with copious amounts of water P534: P534: In case of eye contact: Flush immediately with copious amounts of water P535: P535: In case of eye contact: Flush immediately with copious amounts of water P536: P536: In case of eye contact: Flush immediately with copious amounts of water P537: P537: In case of eye contact: Flush immediately with copious amounts of water P538: P538: In case of eye contact: Flush immediately with copious amounts of water P539: P539: In case of eye contact: Flush immediately with copious amounts of water P540: P540: In case of eye contact: Flush immediately with copious amounts of water P541: P541: In case of eye contact: Flush immediately with copious amounts of water P542: P542: In case of eye contact: Flush immediately with copious amounts of water P543: P543: In case of eye contact: Flush immediately with copious amounts of water P544: P544: In case of eye contact: Flush immediately with copious amounts of water P545: P545: In case of eye contact: Flush immediately with copious amounts of water P546: P546: In case of eye contact: Flush immediately with copious amounts of water P547: P547: In case of eye contact: Flush immediately with copious amounts of water P548: P548: In case of eye contact: Flush immediately with copious amounts of water P549: P549: In case of eye contact: Flush immediately with copious amounts of water P550: P550: In case of eye contact: Flush immediately with copious amounts of water P551: P551: In case of eye contact: Flush immediately with copious amounts of water P552: P552: In case of eye contact: Flush immediately with copious amounts of water P553: P553: In case of eye contact: Flush immediately with copious amounts of water P554: P554: In case of eye contact: Flush immediately with copious amounts of water P555: P555: In case of eye contact: Flush immediately with copious amounts of water P556: P556: In case of eye contact: Flush immediately with copious amounts of water P557: P557: In case of eye contact: Flush immediately with copious amounts of water P558: P558: In case of eye contact: Flush immediately with copious amounts of water P559: P559: In case of eye contact: Flush immediately with copious amounts of water P560: P560: In case of eye contact: Flush immediately with copious amounts of water P561: P561: In case of eye contact: Flush immediately with copious amounts of water P562: P562: In case of eye contact: Flush immediately with copious amounts of water P563: P563: In case of eye contact: Flush immediately with copious amounts of water P564: P564: In case of eye contact: Flush immediately with copious amounts of water P565: P565: In case of eye contact: Flush immediately with copious amounts of water P566: P566: In case of eye contact: Flush immediately with copious amounts of water P567: P567: In case of eye contact: Flush immediately with copious amounts of water P568: P568: In case of eye contact: Flush immediately with copious amounts of water P569: P569: In case of eye contact: Flush immediately with copious amounts of water P570: P570: In case of eye contact: Flush immediately with copious amounts of water P571: P571: In case of eye contact: Flush immediately with copious amounts of water P572: P572: In case of eye contact: Flush immediately with copious amounts of water P573: P573: In case of eye contact: Flush immediately with copious amounts of water P574: P574: In case of eye contact: Flush immediately with copious amounts of water P575: P575: In case of eye contact: Flush immediately with copious amounts of water P576: P576: In case of eye contact: Flush immediately with copious amounts of water P577: P577: In case of eye contact: Flush immediately with copious amounts of water P578: P578: In case of eye contact: Flush immediately with copious amounts of water P579: P579: In case of eye contact: Flush immediately with copious amounts of water P580: P580: In case of eye contact: Flush immediately with copious amounts of water P581: P581: In case of eye contact: Flush immediately with copious amounts of water P582: P582: In case of eye contact: Flush immediately with copious amounts of water P583: P583: In case of eye contact: Flush immediately with copious amounts of water P584: P584: In case of eye contact: Flush immediately with copious amounts of water P585: P585: In case of eye contact: Flush immediately with copious amounts of water P586: P586: In case of eye contact: Flush immediately with copious amounts of water P587: P587: In case of eye contact: Flush immediately with copious amounts of water P588: P588: In case of eye contact: Flush immediately with copious amounts of water P589: P589: In case of eye contact: Flush immediately with copious amounts of water P590: P590: In case of eye contact: Flush immediately with copious amounts of water P591: P591: In case of eye contact: Flush immediately with copious amounts of water P592: P592: In case of eye contact: Flush immediately with copious amounts of water P593: P593: In case of eye contact: Flush immediately with copious amounts of water P594: P594: In case of eye contact: Flush immediately with copious amounts of water P595: P595: In case of eye contact: Flush immediately with copious amounts of water P596: P596: In case of eye contact: Flush immediately with copious amounts of water P597: P597: In case of eye contact: Flush immediately with copious amounts of water P598: P598: In case of eye contact: Flush immediately with copious amounts of water P599: P599: In case of eye contact: Flush immediately with copious amounts of water P600: P600: In case of eye contact: Flush immediately with copious amounts of water P601: P601: In case of eye contact: Flush immediately with copious amounts of water P602: P602: In case of eye contact: Flush immediately with copious amounts of water P603: P603: In case of eye contact: Flush immediately with copious amounts of water P604: P604: In case of eye contact: Flush immediately with copious amounts of water P605: P605: In case of eye contact: Flush immediately with copious amounts of water P606: P606: In case of eye contact: Flush immediately with copious amounts of water P607: P607: In case of eye contact: Flush immediately with copious amounts of water P608: P608: In case of eye contact: Flush immediately with copious amounts of water P609: P609: In case of eye contact: Flush immediately with copious amounts of water P610: P610: In case of eye contact: Flush immediately with copious amounts of water P611: P611: In case of eye contact: Flush immediately with copious amounts of water P612: P612: In case of eye contact: Flush immediately with copious amounts of water P613: P613: In case of eye contact: Flush immediately with copious amounts of water P614: P614: In case of eye contact: Flush immediately with copious amounts of water P615: P615: In case of eye contact: Flush immediately with copious amounts of water P616: P616: In case of eye contact: Flush immediately with copious amounts of water P617: P617: In case of eye contact: Flush immediately with copious amounts of water P618: P618: In case of eye contact: Flush immediately with copious amounts of water P619: P619: In case of eye contact: Flush immediately with copious amounts of water P620: P620: In case of eye contact: Flush immediately with copious amounts of water P621: P621: In case of eye contact: Flush immediately with copious amounts of water P622: P622: In case of eye contact: Flush immediately with copious amounts of water P623: P623: In case of eye contact: Flush immediately with copious amounts of water P624: P624: In case of eye contact: Flush immediately with copious amounts of water P625: P625: In case of eye contact: Flush immediately with copious amounts of water P626: P626: In case of eye contact: Flush immediately with copious amounts of water P627: P627: In case of eye contact: Flush immediately with copious amounts of water P628: P628: In case of eye contact: Flush immediately with copious amounts of water P629: P629: In case of eye contact: Flush immediately with copious amounts of water P630: P630: In case of eye contact: Flush immediately with copious amounts of water P631: P631: In case of eye contact: Flush immediately with copious amounts of water P632: P632: In case of eye contact: Flush immediately with copious amounts of water P633: P633: In case of eye contact: Flush immediately with copious amounts of water P634: P634: In case of eye contact: Flush immediately with copious amounts of water P635: P635: In case of eye contact: Flush immediately with copious amounts of water P636: P636: In case of eye contact: Flush immediately with copious amounts of water P637: P637: In case of eye contact: Flush immediately with copious amounts of water P638: P638: In case of eye contact: Flush immediately with copious amounts of water P639: P639: In case of eye contact: Flush immediately with copious amounts of water P640: P640: In case of eye contact: Flush immediately with copious amounts of water P641: P641: In case of eye contact: Flush immediately with copious amounts of water P642: P642: In case of eye contact: Flush immediately with copious amounts of water P643: P643: In case of eye contact: Flush immediately with copious amounts of water P644: P644: In case of eye contact: Flush immediately with copious amounts of water P645: P645: In case of eye contact: Flush immediately with copious amounts of water P646: P646: In case of eye contact: Flush immediately with copious amounts of water P647: P647: In case of eye contact: Flush immediately with copious amounts of water P648: P648: In case of eye contact: Flush immediately with copious amounts of water P649: P649: In case of eye contact: Flush immediately with copious amounts of water P650: P650: In case of eye contact: Flush immediately with copious amounts of water P651: P651: In case of eye contact: Flush immediately with copious amounts of water P652: P652: In case of eye contact: Flush immediately with copious amounts of water P653: P653: In case of eye contact: Flush immediately with copious amounts of water P654: P654: In case of eye contact: Flush immediately with copious amounts of water P655: P655: In case of eye contact: Flush immediately with copious amounts of water P656: P656: In case of eye contact: Flush immediately with copious amounts of water P657: P657: In case of eye contact: Flush immediately with copious amounts of water P658: P658: In case of eye contact: Flush immediately with copious amounts of water P659: P659: In case of eye contact: Flush immediately with copious amounts of water P660: P660: In case of eye contact: Flush immediately with copious amounts of water P661: P661: In case of eye contact: Flush immediately with copious amounts of water P662: P662: In case of eye contact: Flush immediately with copious amounts of water P663: P663: In case of eye contact: Flush immediately with copious amounts of water P664: P664: In case of eye contact: Flush immediately with copious amounts of water P665: P665: In case of eye contact: Flush immediately with copious amounts of water P666: P666: In case of eye contact: Flush immediately with copious amounts of water P667: P667: In case of eye contact: Flush immediately with copious amounts of water P668: P668: In case of eye contact: Flush immediately with copious amounts of water P669: P669: In case of eye contact: Flush immediately with copious amounts of water P670: P670: In case of eye contact: Flush immediately with copious amounts of water P671: P671: In case of eye contact: Flush immediately with copious amounts of water P672: P672: In case of eye contact: Flush immediately with copious amounts of water P673: P673: In case of eye contact: Flush immediately with copious amounts of water P674: P674: In case of eye contact: Flush immediately with copious amounts of water P675: P675: In case of eye contact: Flush immediately with copious amounts of water P676: P676: In case of eye contact: Flush immediately with copious amounts of water P677: P677: In case of eye contact: Flush immediately with copious amounts of water P678: P678: In case of eye contact: Flush immediately with copious amounts of water P679: P679: In case of eye contact: Flush immediately with copious amounts of water P680: P680: In case of eye contact: Flush immediately with copious amounts of water P681: P681: In case of eye contact: Flush immediately with copious amounts of water P682: P682: In case of eye contact: Flush immediately with copious amounts of water P683: P683: In case of eye contact: Flush immediately with copious amounts of water P684: P684: In case of eye contact: Flush immediately with copious amounts of water P685: P685: In case of eye contact: Flush immediately with copious amounts of water P686: P686: In case of eye contact: Flush immediately with copious amounts of water P687: P687: In case of eye contact: Flush immediately with copious amounts of water P688: P688: In case of eye contact: Flush immediately with copious amounts of water P689: P689: In case of eye contact: Flush immediately with copious amounts of water P690: P690: In case of eye contact: Flush immediately with copious amounts of water P691: P691: In case of eye contact: Flush immediately with copious amounts of water P692: P692: In case of eye contact: Flush immediately with copious amounts of water P693: P693: In case of eye contact: Flush immediately with copious amounts of water P694: P694: In case of eye contact: Flush immediately with copious amounts of water P695: P695: In case of eye contact: Flush immediately with copious amounts of water P696: P696: In case of eye contact: Flush immediately with copious amounts of water P697: P697: In case of eye contact: Flush immediately with copious amounts of water P698: P698: In case of eye contact: Flush immediately with copious amounts of water P699: P699: In case of eye contact: Flush immediately with copious amounts of water P700: P700: In case of eye contact: Flush immediately with copious amounts of water P701: P701: In case of eye contact: Flush immediately with copious amounts of water P702: P702: In case of eye contact: Flush immediately with copious amounts of water P703: P703: In case of eye contact: Flush immediately with copious amounts of water P704: P704: In case of eye contact: Flush immediately with copious amounts of water P705: P705: In case of eye contact: Flush immediately with copious amounts of water P706: P706: In case of eye contact: Flush immediately with copious amounts of water P707: P707: In case of eye contact: Flush immediately with copious amounts of water P708: P708: In case of eye contact: Flush immediately with copious amounts of water P709: P709: In case of eye contact: Flush immediately with copious amounts of water P710: P710: In case of eye contact: Flush immediately with copious amounts of water P711: P711: In case of eye contact: Flush immediately with copious amounts of water P712: P712: In case of eye contact: Flush immediately with copious amounts of water P713: P713: In case of eye contact: Flush immediately with copious amounts of water P714: P714: In case of eye contact: Flush immediately with copious amounts of water P715: P715: In case of eye contact: Flush immediately with copious amounts of water P716: P716: In case of eye contact: Flush immediately with copious amounts of water P717: P717: In case of eye contact: Flush immediately with copious amounts of water P718: P718: In case of eye contact: Flush immediately with copious amounts of water P719: P719: In case of eye contact: Flush immediately with copious amounts of water P720: P720: In case of eye contact: Flush immediately with copious amounts of water P721: P721: In case of eye contact: Flush immediately with copious amounts of water P722: P722: In case of eye contact: Flush immediately with copious amounts of water P723: P723: In case of eye contact: Flush immediately with copious amounts of water P724: P724: In case of eye contact: Flush immediately with copious amounts of water P725: P725: In case of		

Figure 2: Comparison of CPL hazards for methanol, diesel and gasoline according to European Regulation (EC) No 1272/2008. A readable format of the table can be found as appendix 1.

### 1.2.3 Energy content

In terms of energy density methanol has lower energy density compared to petroleum products, thus requiring larger fuel tanks to achieve the same range. For the road ferry the practical result will be that bunkering will be twice as often at about once every week instead of every other.

Table 1: Energy density comparison between different potential fuels and energy carriers.

	Specific energy [MJ/kg]	Energy density [MJ/l]
Methanol	19.7	15.6
Ethanol	26.4	20.9
Diesel	48	35.8
Gasoline	46.4	26
LNG	53.6	22.2
Natural gas	55.5	0.0364
Hydrogen (700 bar)	142	9.17
Lithium-ion 26650 battery	0.53-0.65	

## 2 DESIGN PHILOSOPHY AND REGULATORY FRAMEWORK

In terms of regulations for using methanol as fuel IMO is working on the IGF code that will cover the use of gas and low flashpoint liquids (LFL) as fuel for ships covered by the SOLAS convention. The classification societies DNV GL and Lloyd's Register have also published class rules. For vessels in national traffic there are no particular rules for the use of methanol. When the SUMMETH project started the Swedish Transport Agency TSFS 2014:1 statute did not allow for use of fuels with lower flashpoint than 43°C, similar to the requirements in SOLAS of minimum flashpoint of 60°C. Similar to SOLAS, TSFS 2014:1 also had provisions for alternative designs where risk analysis is used to show that the alternative design is as safe or safer than the prescribed design.

From 1 June 2017 new Swedish national statutes entered in to force, TSFS 2017:26<sup>1</sup>. The new statutes are function based and have no formal requirements on the fuel used on board. Instead the rules require an adequately safe design with little guidelines on actual requirements.

As risk assessment is already a big part of the methanol system design the new statutes do not have a major impact other than removing the formal process of having an *alternative* design.

Prescriptive rules are still used in a sense as the class rules are used as reference in the design process together with experience from the conversion design for both Stena Germanica and the pilot boat conversion of the sister project GreenPilot.



Figure 3: The layers of regulations for installations on ships and boats. The regulations from IMO are not directly applicable but influence the national statutes and class requirements. Class rules are always applicable for ships covered by the international rules and can be for ships in national traffic. Class requirements can also be used in the design and specification of ships in national traffic even though the ship may not have class certificate. The ship can, however, be built with class certificate, as was done for the new Finnish road ferry Elektra.

<sup>1</sup> Transportstyrelsens föreskrifter och allmänna råd om fartyg i nationell sjöfart



### 3 CONVERSION DETAILS

The methanol conversion design was done for the road ferry Jupiter, which is in traffic between Ljusterö and Östanå northeast of Stockholm. The ferry is equipped with four main engines – two in a forward and two in an aft engine room. The engine couple in each end mechanically drives pods on each side. In addition to the propulsion engines each engine room is equipped with gensets. The aft engine room has a diesel burner for a thermal oil heating system.

Jupiter

Year built: 2007

Yard: Työvene OY, Nystad, Finland

Call sign: SFKL

#### Main particulars

$L_{OA}$	86.20 m
$L_{Hull}$	75 m
$L_{CWL}$	73.27 m
Breath <sub>moulded</sub>	15 m
Depth <sub>moulded</sub>	2.95 m
Disp <sub>CWL</sub>	856 ton
Speed	10.0 kn
Passengers	397 pcs
Cars:	60 pcs

Main engines 4 x Volvo Penta D12D-C MH

The ship is approved for speed area E and has no class certificate.

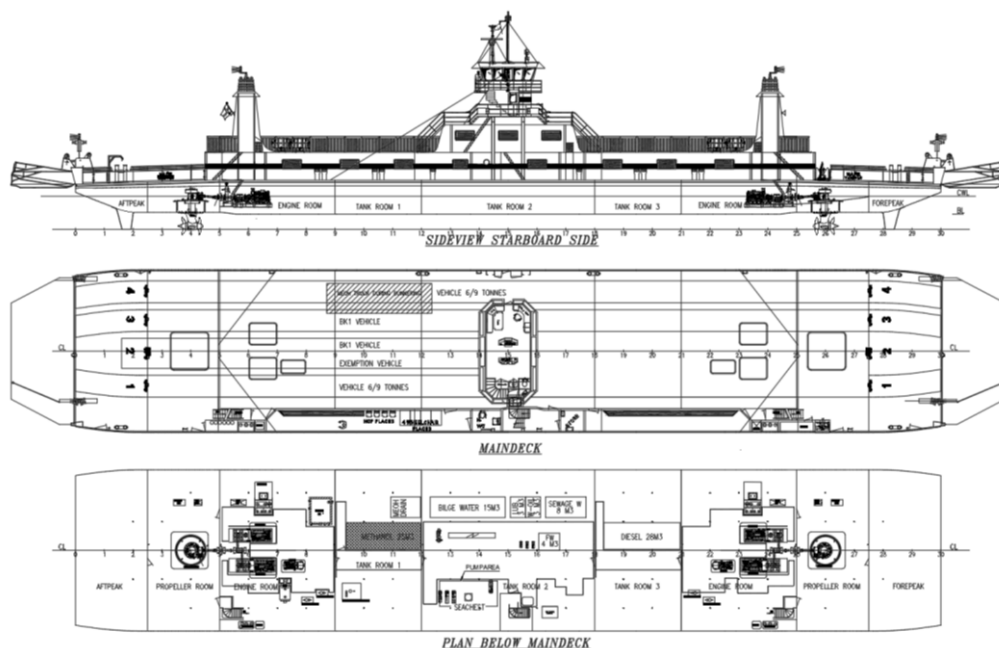

Figure 4: Schematic view of Jupiter below deck. Tank Room 2 in the middle houses water tanks, switchboard and the fire station. The tank rooms on either side (Tank Room 1 to the left and Tank Room 3 to the right) have the diesel tanks and then

*the aft and forward engine room are outside of each tank. The hull and propulsion devices are double symmetrical. Each machinery room has emergency exits to deck through the propeller rooms.*

Reference documents:

Appendix II SNP15095-100 General Arrangement Methanol Conversion

Appendix III SNP15095-707 Hazardous area plan

Appendix IV SNP15095-780 System Coordination Diagram

### 3.1 GENERAL FUNCTIONALITY AND PRINCIPLES OF THE METHANOL SYSTEM

The general principle of the methanol fuel system is similar to any conventional fuel system. The special requirements for the fuel piping such as double walled and limitation on joints are aimed at minimizing the possibility of leakage. The double walled piping is used to provide an outer protective barrier to contain any methanol in case of rupture of the inner pipe.

The methanol fuel tank is located in the aft tank room which is modified with a longitudinal bulkhead to create a new compartment. The fuel pumps are separated from the engines and located in a new pump room together with the equipment that is most likely to cause leakage if it fails during operation or during maintenance. All electrical equipment in the new pump room is EX-approved.

The aft tank is modified and a new longitudinal bulkhead is installed in the existing tank room, thus insulating the new methanol tank room from the ordinary passage way to the engine room. The new methanol tank room is also used as the methanol pump room.

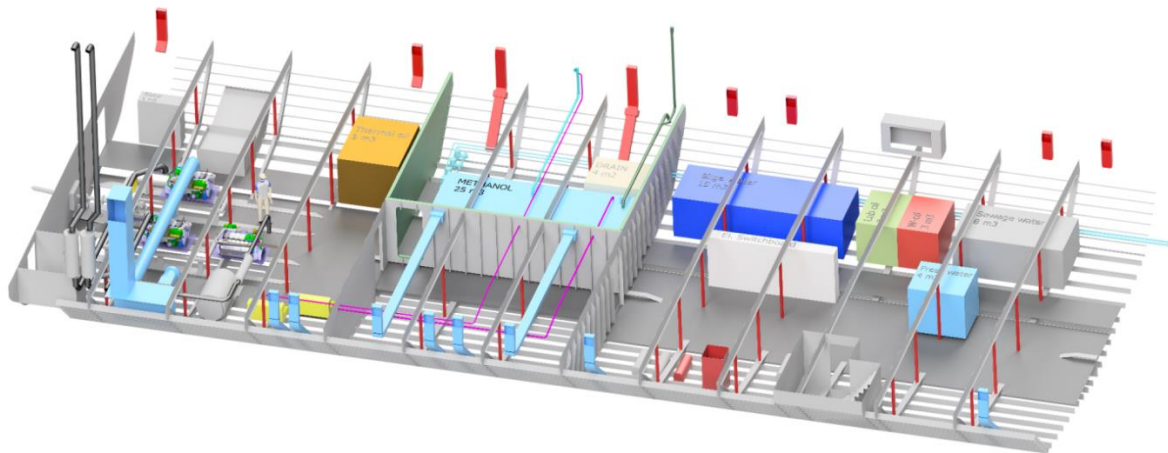

*Figure 5: The methanol tank room is directly aft of tank room 2 in the middle of the ferry. Tank room 2 contains the fire station, electrical switchboard and auxiliary tanks. The machinery room is directly aft of the methanol tank room.*

In addition to the fuel supply system other modifications include upgrading of the safety systems. Both for early detection in case of any methanol leakage and for reducing dangerous consequences in case any such scenario would develop.

### 3.2 METHANOL TANK ROOM

The largest structural modification for the methanol conversion is construction of a new compartment for storage of methanol. The new compartment is part of existing Tank Room 1 where a bulkhead is constructed along the centre line. The new methanol room is to the port side of the bulkhead while starboard side will be a safe passage way to the aft engine room.

The bulkhead along the centre line is watertight and the compartment is equipped with forced ventilation that in case of spillage create an under pressure that will prevent methanol vapours from spreading to other compartments.

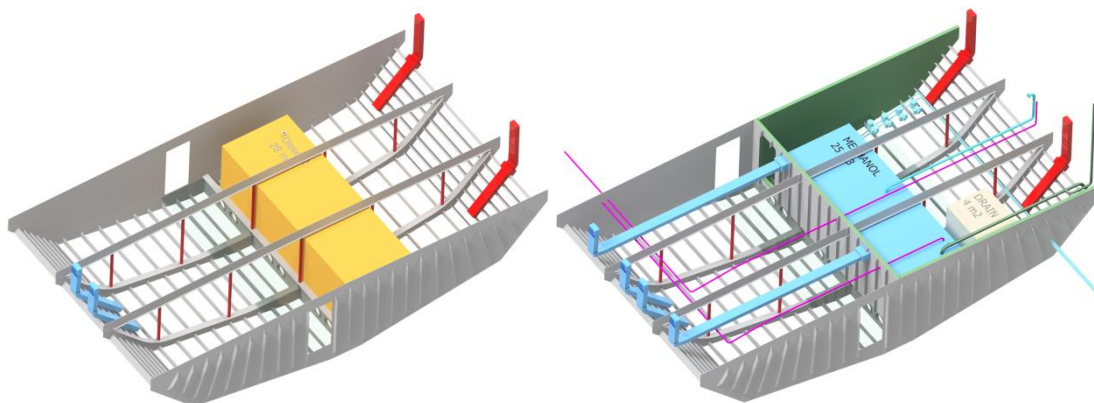

Figure 6: The methanol tank room (tank room 1) before and after conversion. A new watertight bulkhead along the centre line is installed, new ventilation is installed, and the fuel tank is modified for methanol. The compartment is also insulated to ensure fire integrity.

The new compartment is insulated with A60 insulation towards the surrounding spaces. Insulation below the car deck on road ferries is an ongoing discussion. The machinery room has so far been exempted from requirements for insulation towards open deck, the methanol pump room should for fire safety be regarded as machinery room category A and also exempted.

In addition to the tank the new compartment contains fuel pumps, filters and other equipment that is part of the fuel system. The methanol tank room is considered hazardous from a fire safety point of view (Ch. 2.9) and all electrical equipment inside is of EX-type.

Entry to the compartment is through a watertight door aftmost on the new bulkhead. An oxygen meter at the entry alerts persons entering of low oxygen concentration caused by damage to the inertion system. Alarm in case of methanol leaks inside the compartment should also be displayed at the entry.

The forward diesel tank in tank room 3 will remain a diesel tank. The auxiliary engines and the thermal oil heater will not be converted to methanol in a first stage. Keeping the diesel system also allows the main engines to be converted one by one to methanol in order to properly test the systems on board. The forward tank could at a later stage be upgraded to make the ferry fully operational on methanol.

### 3.3 METHANOL TANK

The methanol tank is located inside the new tank room. The existing tank is either modified or a new independent tank is installed in its place. The tank needs to be somewhat shorter than the existing diesel tank to allow enough space for the new tank room door. The volume of the methanol tank is 25 m<sup>3</sup> while the existing diesel tank is 28 m<sup>3</sup>.

The master fuel valves are remotely operated solenoid valves that are closed when methanol engines are not in operation.

Methanol is corrosive, especially if water is present in the fuel. The inside of the tank should be coated for protection; Sigma Silguard 750 is a proven product but other alternatives are available. Alternatively the tank can be built of stainless steel, especially for smaller applications.

Inspection hatches allow for inspection of the tank internals. Remote tank level measurement and a separate high-high alarm are required.

### 3.3.1 Tank inertion

The rules for use of low flashpoint fuels on SOLAS ships require fuel tanks to be inerted. Inertion is also required for transporting large quantities of some flammable products in bulk as defined in the IBC code; bulk transport of methanol does not require inertion at this time but is being discussed. Inertion is however often used when transporting methanol in large quantities at sea but not for barges and trucks.

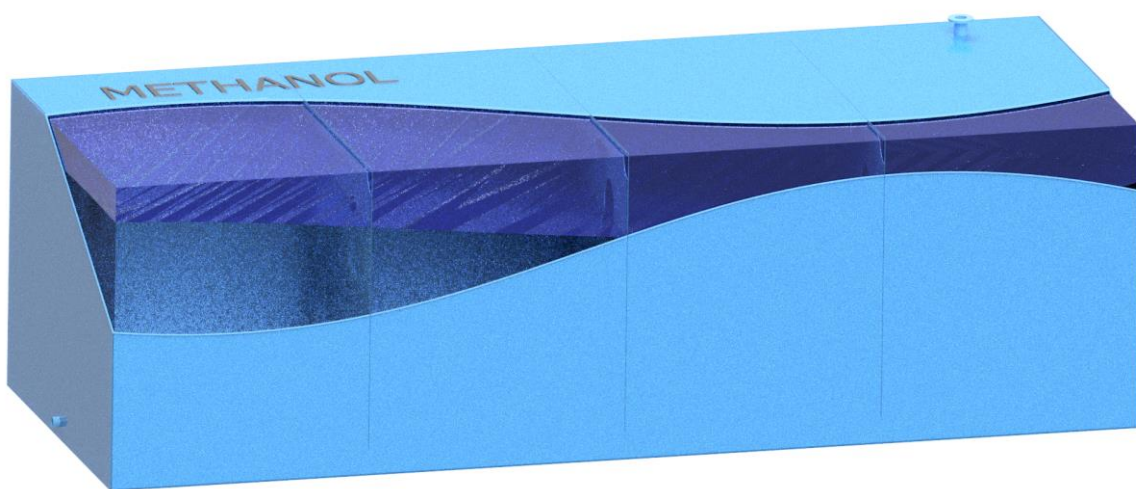

Figure 7: The methanol tank. Nitrogen gas covers the methanol surface to ensure that no combustible gases can form.

The inertion ensures that no combustible atmosphere can possibly exist inside the tanks by suppressing the oxygen level. Inertion is also held at a slight overpressure, above the vapour pressure of methanol to further ensure that fuel vapours in the tank will be suppressed.

In addition to inertion of the tanks nitrogen is used to purge the fuel pipes before service to ensure a safe working environment and minimize the fire hazard.

Nitrogen can either be supplied by portable bottles or from an on board nitrogen generator.

#### 3.3.1.1 Portable bottles

Nitrogen is readily available as compressed gas in portable bottles. As nitrogen gas is supplied to the fuel tank at the same rate as fuel is burnt in the engines, nitrogen consumption is as large as the methanol consumption, i.e. approximately 1.14 m<sup>3</sup>/day. During a fuel cycle the corresponding nitrogen consumption would be 2.6 50-litre bottles of nitrogen. With refill every other week the nitrogen store on board would need to be 6 bottles.

#### 3.3.1.2 Nitrogen generator

An alternative to exchangeable bottles is to install a nitrogen generator on board. The costs of the generator need to offset the cost of the gas bottles including work for bottle changes.

In order to power the nitrogen generator a compressed air supply system is needed including dryer and filter for the air. A pressure tank to store the compressed nitrogen is also needed.

The nitrogen generator arrangement has not been studied in the hazid workshops but does not provide significant additional hazards. Measures to ensure a breathable atmosphere in the nitrogen storage/generator compartment are similar.

An on board inert gas generator provide significant advantages in terms of logistics and maintenance as the need for bottle exchange is mitigated. The investment cost is higher but is somewhat offset by the absence of gas and bottle costs.

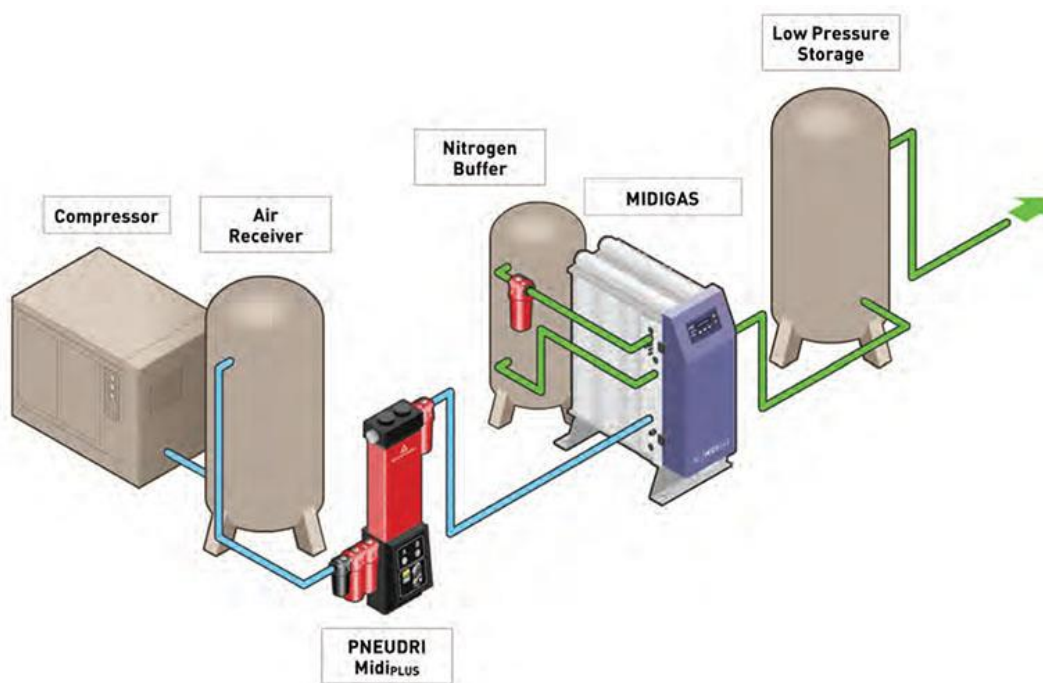

Figure 8: Principal layout of an inert gas generator. Image courtesy of: [parker.com](http://parker.com)

The cost of a nitrogen generator is estimated to be approximately 240 000 SEK compared to an annual cost of about 90 000 SEK for the portable bottles. These costs do not include the distribution system which would be similar in both cases.



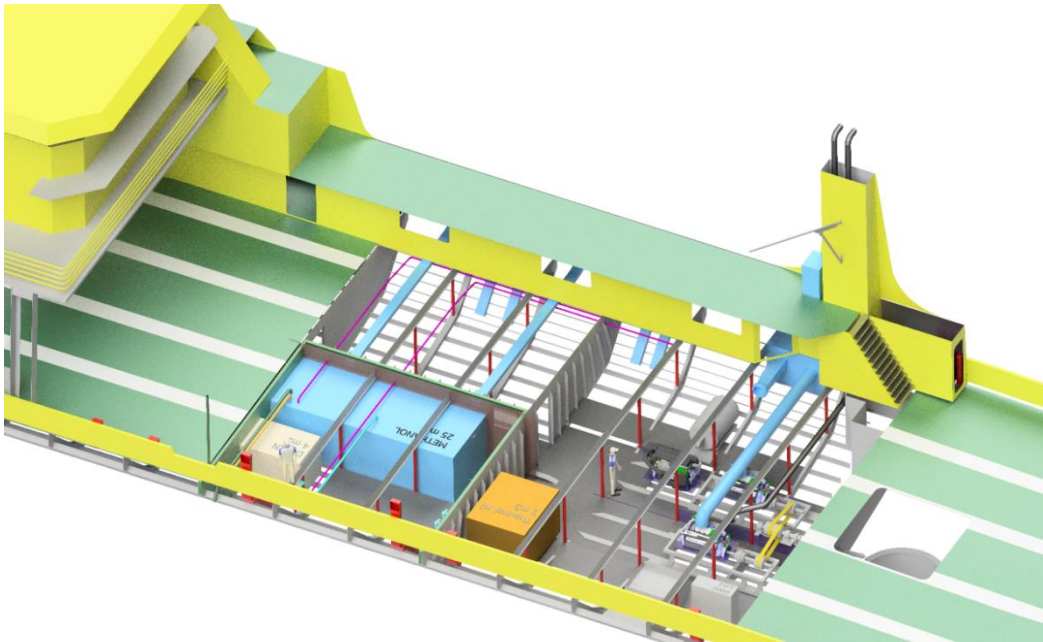

Figure 9: The aft store on port side where gas bottles for the fire extinguishing system is stored is also the proposed location for the inert gas system. In order to fit a nitrogen generator the store would most likely need to be somewhat expanded. The compartment has access from the outside and is easily ventilated which are requirements when generating inert gas.

### 3.3.2 Tank Ventilation

As the tank is pressurised by nitrogen the tank ventilation needs to be specially designed for methanol. The pressure is contained through the use of a P/V valve at the end of the ventilation pipe. The P/V valve will open if the overpressure exceeds 150 mBar(g). The valve will also open if the pressure is below 50 mBar(g) vacuum in order not to damage the tank.

As vapours from the tank ventilation could possibly contain methanol the ventilation is higher than for a conventional installation. The ventilation pipes extend 3 m above deck, in line with the requirements in the IGF code.

### 3.3.3 Emergency overflow

An emergency overflow line is fitted on the tank ventilation pipe. If the tank is overfilled during bunkering, despite high and high-high alarms, methanol will overflow to the outside. The overflow pipe is fitted with a rupture disk, with alarm, that will break in case of overfill to allow methanol in the pipe to flow through.

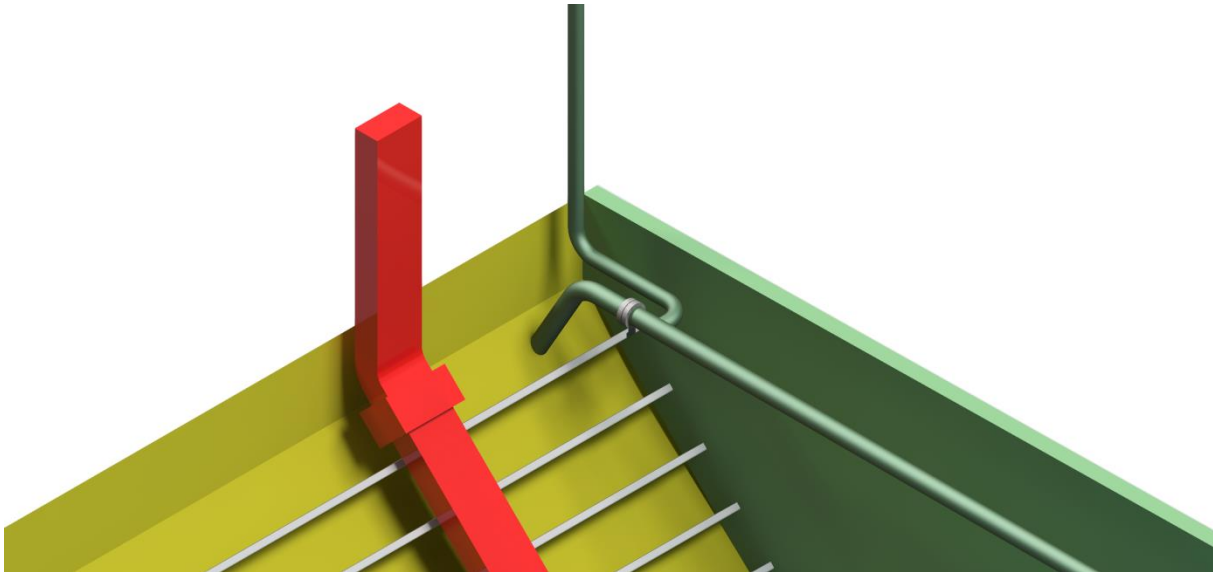

Figure 10: The tank ventilation and overflow pipe. The tank ventilation pipe extends through the deck and upwards while the overflow pipe penetrates the shell plating. A burst disk is fitted on the pipe to stop nitrogen from escaping and seawater from entering the piping.

### 3.3.4 Bunker connection

The bunker connection used for methanol is a dry disconnect fast coupling. Both parts of the connection are closed as long as they are not connected. This ensures no spillage during bunkering. The bunker connection is of a similar type as used for the Stena Germanica methanol bunkering and for the GreenPilot project.

The bunker connection is located on deck above the methanol tank. Bunkering will be done from a truck where the truck parks on deck close to the bunker manifold, similar to how diesel is bunkered today.

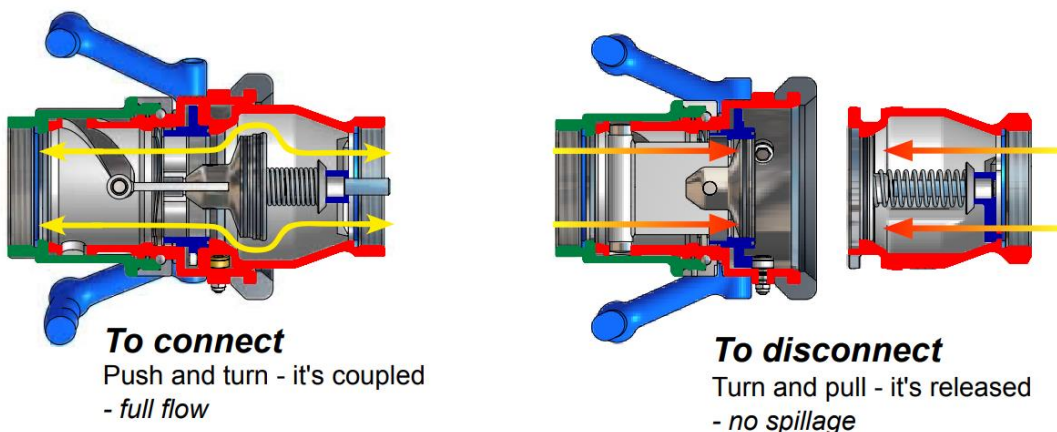

Figure 11: Illustration of the connection type engaged and disengaged. Image courtesy of MannTek.

Bunkering of methanol is done the same way as bunkering diesel fuel where a truck drives on board and parks close to the bunker manifold. Methanol is routinely transported in tank trucks and discharged by the driver at a large variety of facilities.

The truck is connected to the ferry via the drip free dry disconnect coupling whereas bunkering is started by opening the valves on the bunker line.

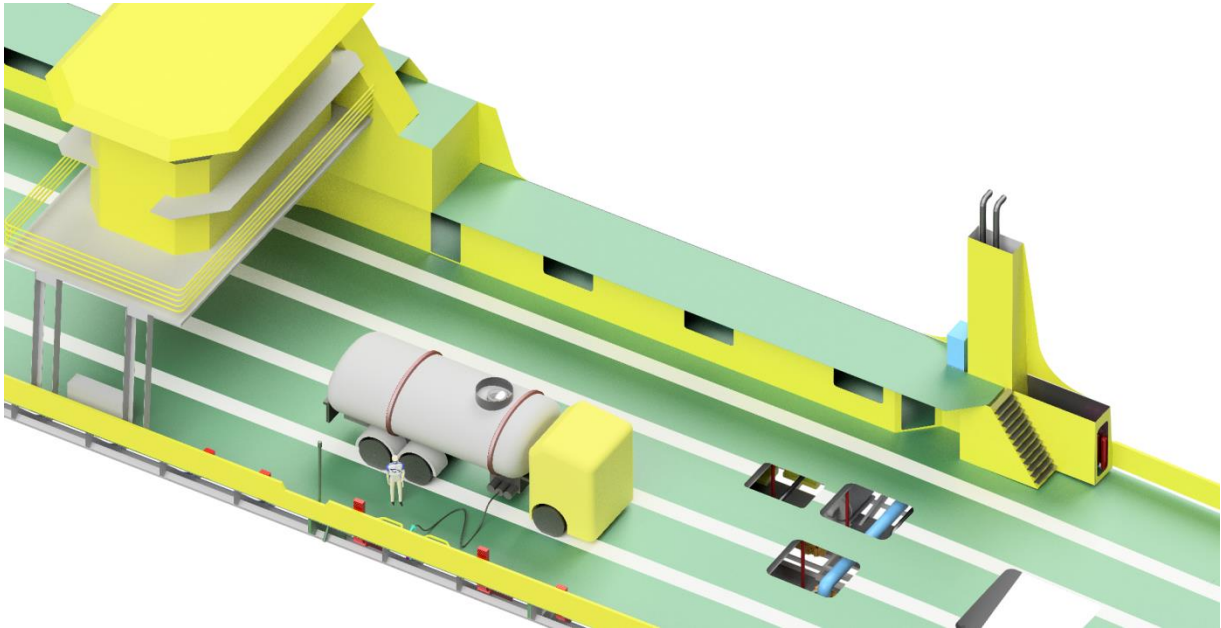

Figure 12: The truck carrying methanol parks on deck close to the bunker manifold. During bunkering no passengers are on board.

During bunkering the ferry is at port and no passengers are allowed on board.

### 3.4 FUEL SYSTEM

As the design relies heavily in containing methanol, double walled fuel pipes are used in all areas outside of the pump room, with the exception of the bunker pipe protruding on open deck.

The outer wall of the piping acts as a second barrier to contain methanol in case of rupture of the inner pipe but also as protection from mechanical damage from the outside. For larger dimensions double walled pipes are manufactured for the application but for the smaller dimensions as required for this case double walled pipes can be bought off the shelf.

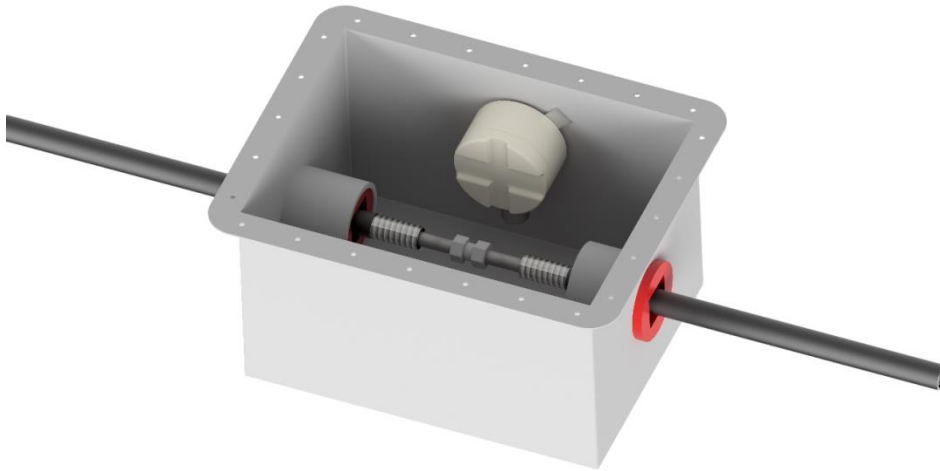

Figure 13: Detailed view of FLEXWELL Safety Pipe. An inner stainless steel pipe protected by a rubber covered corrugated steel pipe.

The inner pipe is a smooth stainless steel pipe for fuel delivery and the outer pipe corrugated with rubber coating. The pipe is delivered on roll and can be bent with conventional methods during assembly. For installations the joints should be as few as practically possible and located inside



protected joint boxes at low points. Potential leakage will drain to the box where gas detectors will indicate presence of vapours. The annular space will not be ventilated as installations on large ships would require. The location of the box and necessary number of boxes is to be determined during installation but would most likely be necessary somewhere between the methanol room and the forward engine room.



*Figure 14: Pipe joints are protected inside a steel box in order to satisfy the requirements of a secondary barrier in all locations outside of the safe compartments. In case of leakage methanol will drain to the box where vapours will be detected by the gas detector.*

The principal layout for the fuel system is to place individual fuel pumps for each engine inside the methanol tank room with drip drays to collect and detect leakage from the individual units. Fuel lines to each engine are thereafter routed for each engine. For the aft engines the pipes go straight to the machinery room while fuel pipes to the forward engines pass through Tank Room 1 and Tank Room 2. Each fuel line has remotely operated shutoff valves to kill the fuel supply if necessary.

The fuel supply system has a working pressure of about 3 bar.

#### 3.4.1 Component selection

In order to secure reliable operation all components used in the fuel system are stainless steel. It is also important to select sealing materials that are compatible with methanol during component selection.

### 3.5 MACHINERY ROOM AND ENGINES

The engine room modifications necessary for safe operation on methanol are minor. The engines are swapped for methanol converted engines and the fuel supply pipes are changed to double walled pipes.

Detailed specifications of the engines are at this point not available. The most likely engine technology in the short term is spark ignited engines with a low pressure fuel supply system, which is very similar to the concept tried in the GreenPilot project. See SUMMETH Report D3 for further details on methanol engines.

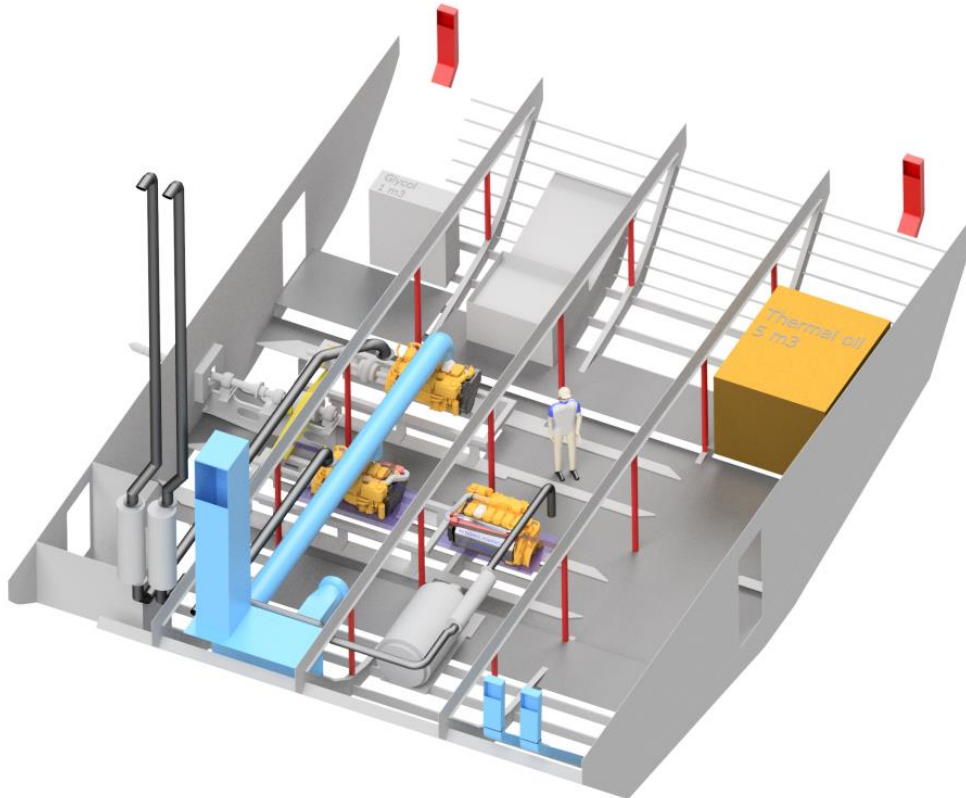

Figure 15: The aft engine room layout with the three combustion engines shown in orange. Two of the engines are connected to a belt drive that drives the shuttle. The third engine drives an electric generator. The aft engine room is also equipped with a diesel burner and thermal oil tank for heating in the superstructure.

### 3.6 VAPOUR DETECTION

The methanol system is designed to prevent any leakage of methanol, with double walled piping in all areas except the methanol tank room, which is considered safe as all equipment is EX-proof inside. If any methanol leakage would still occur vapour detectors are used to detect traces of methanol. Inside the engine room detectors are located close to each engine. Detectors are also installed inside the tank room to detect any leakage from the pumps or connectors.

Methanol vapour detection is efficient and small traces are easily detected. Hand held equipment can detect very small amounts of methanol inside a compartment, down to a few ppm. For reference the long term exposure limit is 250 ppm<sup>2</sup> and the lower explosion limit (100% LEL) is 60000 ppm.

The gas detection system will monitor the detectors continuously and alarms will go off in case of gas concentration of 15% LEL and 30% LEL.

The gas detectors provide early warning in case of technical faults to the system and allow the operator to prevent a dangerous situation from developing.

### 3.7 FIRE DETECTION

As a methanol fire produces virtually no soot and particles, smoke detectors will not work reliably for methanol. It is therefore necessary to install an additional detection system. In the proFLASH project, SP (now RISE) have conducted practical tests of fire suppression and detection of methanol fires for marine applications. The tests showed that infrared (IR) detectors certified for ethanol work well for

<sup>2</sup> AFS 2015:7: Hygieniska gränsvärden

detecting methanol fires, even when the fire itself is obstructed from the detector's direct line of sight. The IR detectors work by detecting radiation from the fire, radiation from CO<sub>2</sub> in particular is a strong indicator of fire. Detectors purely working in the visual spectrum are, however, not suitable for methanol.

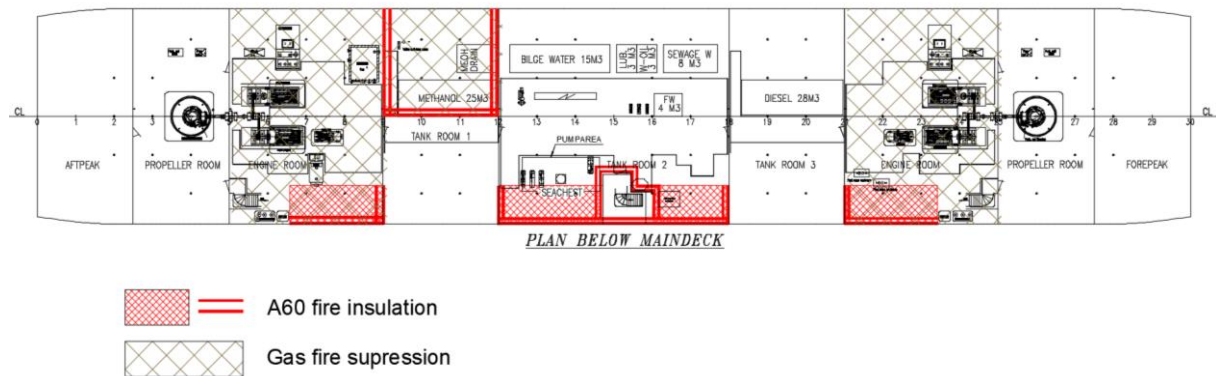

Figure 16: Fire insulation and gas fire suppression system below main deck. Fire insulation and fire suppression in the new room are new.

On the road ferry IR detectors are recommended in the engine rooms. In the pump room heat detectors would also work good as no other heat sources could cause alarms and enough heat would also quickly accumulate to trigger an alarm in case of fire.

Smoke detectors should, however, still be used for indication of fires from other sources. A methanol fire would also quickly start to emit smoke as it spread to electrical cables and other materials.

### 3.8 FIRE SUPPRESSION

The ship is equipped with a water based fixed fire fighting system. The system consists of two water cannons on the boat deck (above main deck) and connection points for fire hoses on main deck and in all the compartments below deck (bar aft and forepeak). A portable foam nozzle and foam agent is located in the forward store on main deck. A sprinkler system is installed towards the bulkhead of the superstructure towards the main deck (capacity at least 0.6 m<sup>3</sup> water/m<sup>2</sup> wall area per hour). Two fire pumps supply the system from the sea chest, both are located in tank room 2 midships.

The engine rooms are protected with a total flooding inert gas system (type FS 49 C2). The system is designed to quench a fire in one of the engine rooms from portable bottles located in the aft store.

A methanol fire would require more gas to achieve the same effect with the gas total flooding system in the machinery room. The gas fire extinguishing system is to be expanded to the methanol tank room.

#### 3.8.1 Deck wash system

A new deck wash system is to be installed. This is a system in use on the newer ferries in order for structural protection of the deck between the engine room and ro-ro-deck above. Normally, the deck has no other fire insulation whereas fire insulation is normally required between machinery space of category A and cargo deck.

As a deck wash system is required on new ferries it is reasonable to have it installed when a methanol conversion is done. The deck wash system would also be used in case of a major spill during bunkering in which case water would be used to dilute and evacuate the methanol overboard.

### 3.9 HAZARDOUS AREA PLAN

When working with flammable liquids or gases classification plans are used to identify areas where flammable liquids, vapours or gas can be expected to exist. A hazardous area plan for the road ferry identifies these locations and divides them in three categories as defined by DNV GL class rules for low flashpoint fuels.

#### DNV GL Rules for classification - Part 6 Chapter 2 Section 6

Part 6 Additional class notations

Section 6 Low flashpoint liquid fuelled engines - LFL FUELLED

**Hazardous area** is an area in which an explosive gas atmosphere is or may be expected to be present, in quantities such as to require special precautions for the construction, installation and use of electrical apparatus. Hazardous areas are divided into Zone 0, 1 and 2 as defined below and according to the area classification specified in [5.2].

Zone 0 = Area in which an explosive gas atmosphere is present continuously or is present for long periods.

Zone 1 = Area in which an explosive gas atmosphere is likely to occur in normal operation.

Zone 2 = Area in which an explosive gas atmosphere is not likely to occur in normal operation and, if it does occur, is likely to do so only infrequently and will exist for a short period only.

Guidance note: *The definition of hazardous area is only related to the risk of explosion. In this context, health, safety and environmental issues, i.e. toxicity, is not considered.*

The class rules clearly define the areas to be classified as hazardous. The inside of the fuel tank is Zone 0 and the methanol pump room is classified as Zone 1 in line with the regulations. Deviations from the regulations are necessary on open deck as the rules define a radius around ventilation openings and a tank P/V valve is not suitable for smaller vessels. For large fuel tanks and large ships the potential volumetric flow is much greater and thus a larger zone with potentially flammable vapours will form around the outlet. For smaller vessels the volume with vapours will be much smaller and the vapours will dissolve in air faster. The hazardous area around the ventilation outlets and tank P/V valve is, on the road ferry, defined to a one meter radius around the centre point of the ventilation outlet. The corresponding class rules stipulate a radius of 4.5 m around ventilation outlets and 10 m radius around the P/V valve.

The illustration bellow shows the hazardous zones for the road ferry. During normal operation the areas on deck as well as the air in the pump room will not contain any trace of methanol. During bunkering the P/V valve will open but as the methanol fuel tank is inerted with nitrogen the exhaust will contain mostly nitrogen with only trace amounts of methanol well below any flammable or toxic concentration.

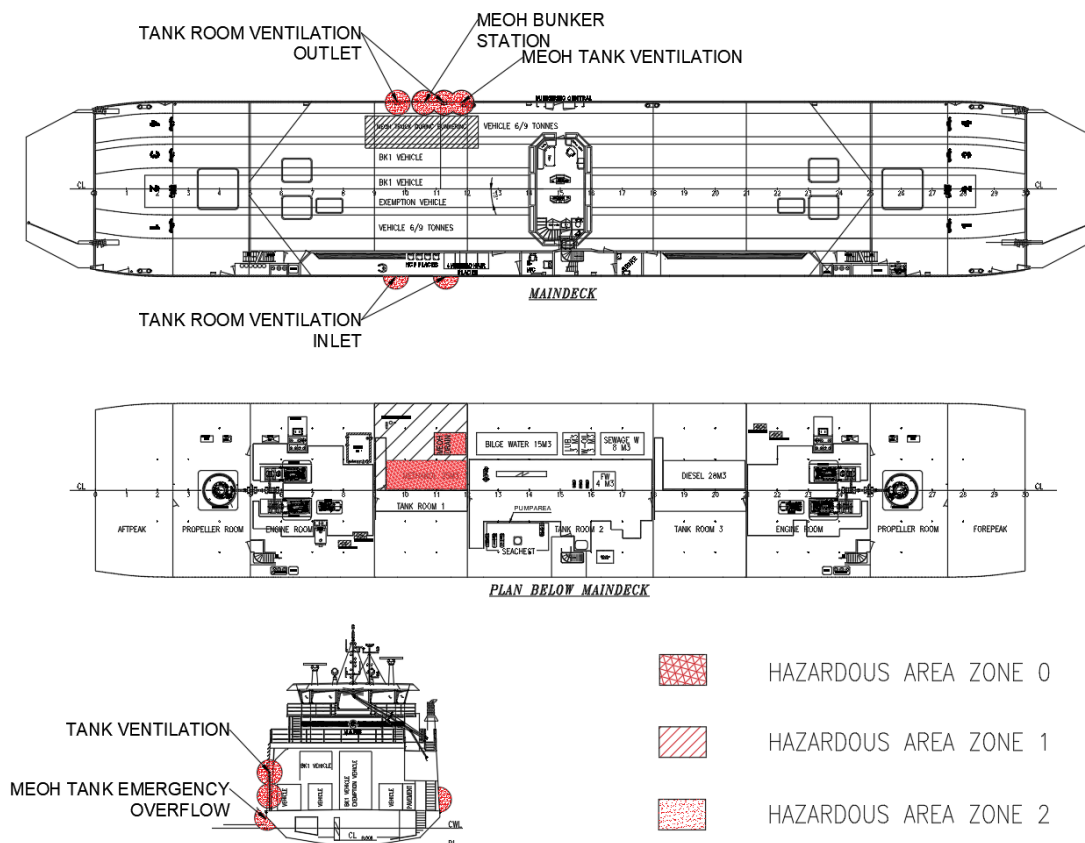

Figure 17: The hazardous areas. The pump room and ventilation inlets and outlets are by definition classified as hazardous areas.

### 3.10 MAJOR DESIGN ALTERNATIVES

#### 3.10.1 Alternative to tank inertion

The possibility of using atmospheric tanks with no inertion has been considered. For smaller vessels this is a reasonable departure from the regulations and alcohols are regularly stored in atmospheric tanks without inertion. Transport of methanol on land by truck or train is generally done without any tank inertion and tank storage on land does not use inertion either. Land based storage facilities may on the other hand be equipped with floating roofs to counteract formation of a vapour layer or have in-tank fire extinguishers. For transport of methanol in bulk at sea the IBC code (for SOLAS ships) also does not require inertion for methanol. However, inertion is still a common feature for methanol carriers as a requirement from the cargo owner and there are discussions of tightening the rules as some accidents have happened when the cargo has caught fire.

With this in mind the decision was made to include tank inertion to ensure safety of the ship. The possible dangers of handling inert gas in the closed compartments have been determined to be lower than the possible consequences of alternative designs.

The possibility of using atmospheric storage could be further investigated but would need to be conducted in cooperation with the class and entities familiar with handling large quantities of methanol in bulk.

A consequence of tank inertion would be atmospheric tank ventilation with no need for a P/V valve. A flame arrestor should in that case be fitted to the ventilation line. In case of fire outside of the tank

ventilation the flame arrester stops a flame from propagating to the tank through the ventilation pipe. The flame arrester is a passive device.

### 3.10.2 Methanol tank bladder

The proposed design has a separate compartment for the methanol tank. The new compartment is gas tight towards the rest of the vessel with an independent ventilation system. Any damage to the methanol tank resulting in spillage would therefore be contained without risk of methanol entering any other part of the vessel, thus satisfying the requirements of secondary boundary around low flashpoint fuel tanks. An alternative to a fully separate compartment is an internal tank bladder. The internal bladder would be the primary container of the fuel while the tank would act as the secondary barrier.

There are commercial marine tank bladders for use with ethanol available on the market but these are much smaller than what would be required for the ferry case and are intended to be used without an outer shell.



*Figure 18: A tank bladder from Aero Tec Laboratories Inc. Marine tank bladders are available for any commercially available fuel, including ethanol blends.*

With the tank equipped with an internal bladder the design could move away from the methanol tank room. Fuel pumps and equipment would still need to be isolated but could be housed inside independent steel pump chests. The pump chest would contain any methanol spillage from the equipment and provide good serviceability of the equipment. The design is similar to the Gas Valve Units used on some LNG ships and the pump chest in the methanol powered GreenPilot project.

## 4 DISCUSSION AND CONCLUSIONS

---

Converting a road ferry to methanol is a realistic undertaking. The arrangements on board with space available below the deck allows for a safe design and also arrangements that should satisfy all requirements for monitoring and serviceability. Auxiliary systems have been kept to a minimum but with the overall goal to ensure safe and reliable operation on methanol.

From a technical point of view all parts of the design should be able to work with few problems during installations. The major question mark for commercial operation on methanol at this point is the availability of engines but from a technical point of view methanol does not provide a huge challenge.

Efficiency wise similar efficiency as a conventional ferry should be expected, resulting in bunkering methanol about twice as often to compensate for the lower heating value of the fuel.

The ferry is designed with two independent engine rooms, each equipped with two main engines mechanically connected to a propeller pod. During normal operations all engines are often running on very low load, resulting in poor efficiency and high relative emissions. Efficiency wise running on fewer engines is better but will also result in less redundancy.

## 5 REFERENCES

---



DNV GL Rules for classification - Part 6 Chapter 2 Section 6

Evegren F. proFLASH: Methanol fire detection and extinguishment : SP Rapport 2017:22 [Internet]. 2017. (SP Rapport). Available from: <http://urn.kb.se/resolve?urn=urn:nbn:se:ri:diva-29442>

IGF Code: International Code of Safety for Ships Using Gases or Other Low-Flashpoint Fuels, 2016 Edition (I109E)



## APPENDIX I – SAFETY DATA SHEETS

Product	Gasoline MK1 93.5, 95, 96, 98 (CAS 86290-81-5)	Diesel (CAS 68334-30-5)	Methanol
Source	St1 Refinery AB	St1 Refinery AB	Methanex Europe S.A
Appearance:	Pale yellow, clear liquid	Clear liquid, colourless, yellow or green	Clear
Odour:	Characteristic	Characteristic	Alcohol odour
Odour threshold:	-	-	4,2 - 5960 ppm
pH:	Not applicable	Not applicable	Not applicable
Melting point/freezing point:	< -60 °C	< -10 °C	-97,8°C
Initial boiling point and boiling range:	25 - 205°C	160 - 370°C	64,7°C
Flash point:	< -40 °C	>56 °C	11°C
Evaporation rate:	-	-	-
Flammability (solid, gas)	-	-	Highly flammable liquid and vapour
Upper/lower flammability or explosive limits:	1 – 8 vol %	0,6 – 7,5 vol %	5,5 - 36,5 vol %
Vapour pressure:	45 - 95 kPa @ 37,8 °C	<0,5 kPa @ 37,8 °C	12,8 kPa @ 20°C
Relative vapour density @ 20oC:	-	.	1.1
Relative density:	720 - 775 kg/m3	820 - 860 kg/m3	791 – 793 kg/m3
Solubility(ies):	Low solubility	Not solubility	Miscible with water
Auto-ignition temperature:	> 250°C	> 225°C	464°C
Kinematics Viscosity, 40°C	< 1 mm2/s	1 - 5 mm2/s	
Explosive properties:	Not considered to be explosive	Not considered to be explosive	Vapours may form explosive mixture with air.
Oxidising properties:	Not considered to oxidise	Not considered to oxidise	Not oxidising.
Hazard pictograms (CPL)			
Signal word: (CPL)	Danger	Danger	Danger
Hazard statements (CPL)	<p>H224: Extremely flammable liquid and vapour.</p> <p>H304: May be fatal if swallowed and enters airways</p> <p>H315: Causes skin irritation</p> <p>H340: May cause genetic defects</p> <p>H350: May cause cancer</p> <p>H361: Suspected of damaging fertility or the unborn child</p> <p>H336: May cause drowsiness or dizziness</p> <p>H411: Toxic to aquatic life with long lasting effects</p>	<p>H226: Flammable liquid and vapour.</p> <p>H304: May be fatal if swallowed and enters airways.</p> <p>H315: Causes skin irritation.</p> <p>H332: Harmful if inhaled.</p> <p>H351: Suspected of causing cancer.</p> <p>H373: May cause damage to organs through prolonged or repeated exposure.</p> <p>H411: Toxic to aquatic life with long lasting effects</p>	<p>H225 Highly flammable liquid and vapour.</p> <p>H301 Toxic if swallowed.</p> <p>H311 Toxic in contact with skin.</p> <p>H331 Toxic if inhaled.</p> <p>H370 Causes damage to organs.</p>
Precautionary statements (CLP)	<p>P201: Obtain special instructions before use</p> <p>P202: Do not handle until all safety precautions have been read and understood</p> <p>P210: Keep away from heat/sparks/open flames/hot surfaces - No smoking</p> <p>P233: Keep container tightly closed</p>	<p>P201: Obtain special instructions before use</p> <p>P210: Keep away from heat/sparks/open flames/hot surfaces – No smoking</p> <p>P240: Ground/bond container and receiving equipment</p> <p>P241: Use explosion-proof electrical/ventilation/ lightning</p>	<p>P210 - Keep away from heat. - No smoking</p> <p>P280 - Wear protective gloves, protective clothing, eye protection, face protection</p> <p>P304+P340 - IF INHALED: remove victim to fresh air and keep at rest in a position comfortable for breathing</p>

	<p>P240: Ground/bond container and receiving equipment</p> <p>P241: Use explosion-proof electrical/ventilation/ lightning equipment</p> <p>P242: Use only non-sparing tools</p> <p>P243: Take precautionary measures against static discharge</p> <p>P261: Do not breath fume/gas/mist/vapours/spray</p> <p>P264: Wash hands thoroughly after handling</p> <p>P271: Use only outdoors or in a well-ventilated area</p> <p>P273: Avoid release to the environment</p> <p>P280: Wear protective gloves/clothing/eye protection</p> <p>P301+P310: IF SWALLOWED: Immediately call a POISON CENTER or doctor/physician</p> <p>P302+P352: IF ON SKIN: Wash with plenty of soap and water</p> <p>P303+P361+P353: IF ON SKIN (or hair): Remove/Take off immediately all contaminated clothing. Rinse skin with water/shower</p> <p>P304+P340: IF INHALED: Remove victim to fresh air and keep at rest in a position comfortable for breathing</p> <p>P308+P313: IF exposed or concerned: Get medical advice/attention</p> <p>P312: Call a POISON CENTER or doctor/physician if you feel unwell</p> <p>P331: Do NOT induce vomiting</p> <p>P332+P313: If skin irritation occurs: Get medical advice/attention</p> <p>P370+P378: In case of fire: Use water spray or foam for extinction</p> <p>P391: Collect spillage</p> <p>P403+P235: Store in a well-ventilated place. Keep cool</p> <p>P405: Store locked up</p> <p>P501: Dispose of contents/container in accordance with local/regional/national/international regulation</p>	<p>equipment</p> <p>P242: Use only non-sparing tools</p> <p>P243: Take precautionary measures against static discharge</p> <p>P260: Do not breathe dust/fume/gas/vapours/spray</p> <p>P264: Wash hands thoroughly after handling</p> <p>P270: Do not eat, drink or smoke when using this product</p> <p>P273: Avoid release to the environment</p> <p>P280: Wear protective gloves/clothing/eye protection</p> <p>P301+P310: IF SWALLOWED: Immediately call a POISON CENTER or doctor/physician</p> <p>P302+P352: IF ON SKIN: Wash with plenty of soap and water</p> <p>P303+P361+P353: IF ON SKIN (or hair): Remove/Take off immediately all contaminated clothing. Rinse skin with water/shower</p> <p>P304+P340: IF INHALED: Remove victim to fresh air and keep at rest in a position comfortable for breathing</p> <p>P308+P313: IF exposed or concerned: Get medical advice/attention</p> <p>P312: Call a POISON CENTER or doctor/physician if you feel unwell</p> <p>P331: Do NOT induce vomiting</p> <p>P332+P313: If skin irritation occurs: Get medical advice/attention</p> <p>P370+P378: In case of fire: Use water spray or foam for extinction</p> <p>P391: Collect spillage</p> <p>P403+P233: Store in a well-ventilated place. Keep container tightly closed</p> <p>P403+P235: Store in a well-ventilated place. Keep cool</p> <p>P405: Store locked up</p> <p>P501: Dispose of contents/container in accordance with local/regional/national/international regulation</p>	<p>P303+P361+P353 - IF ON SKIN (or hair): Remove/Take off immediately all contaminated clothing. Rinse skin with water/shower</p> <p>P301+P310 - IF SWALLOWED: Immediately call a POISON CENTRE or doctor</p> <p>P403+P235 - Store in a well-ventilated place. Keep cool</p>
--	--	--	--

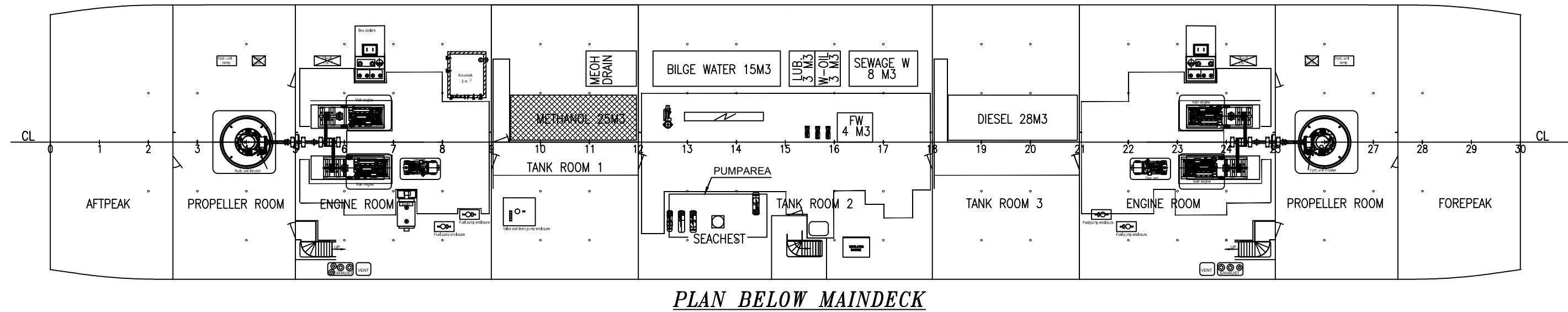
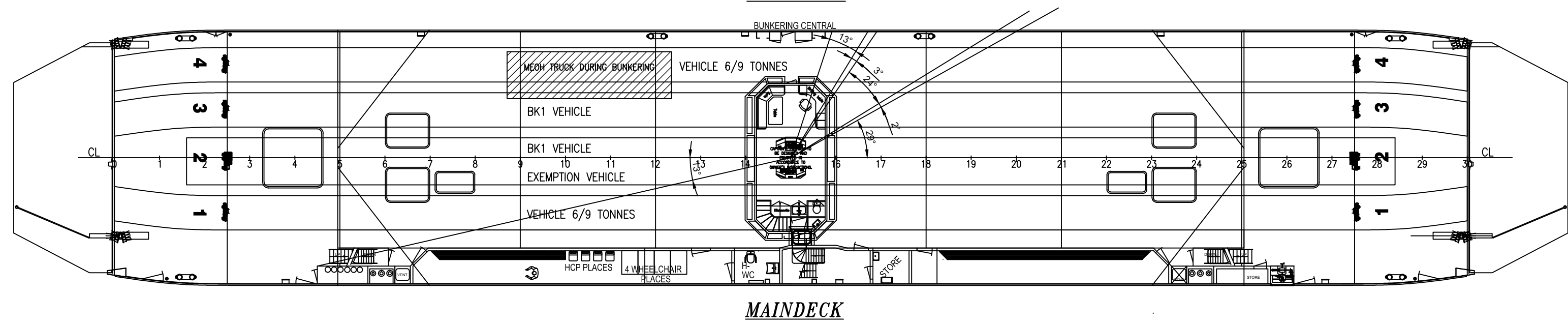
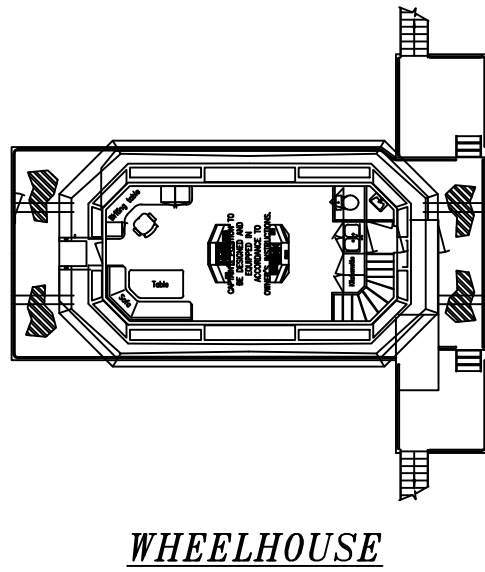
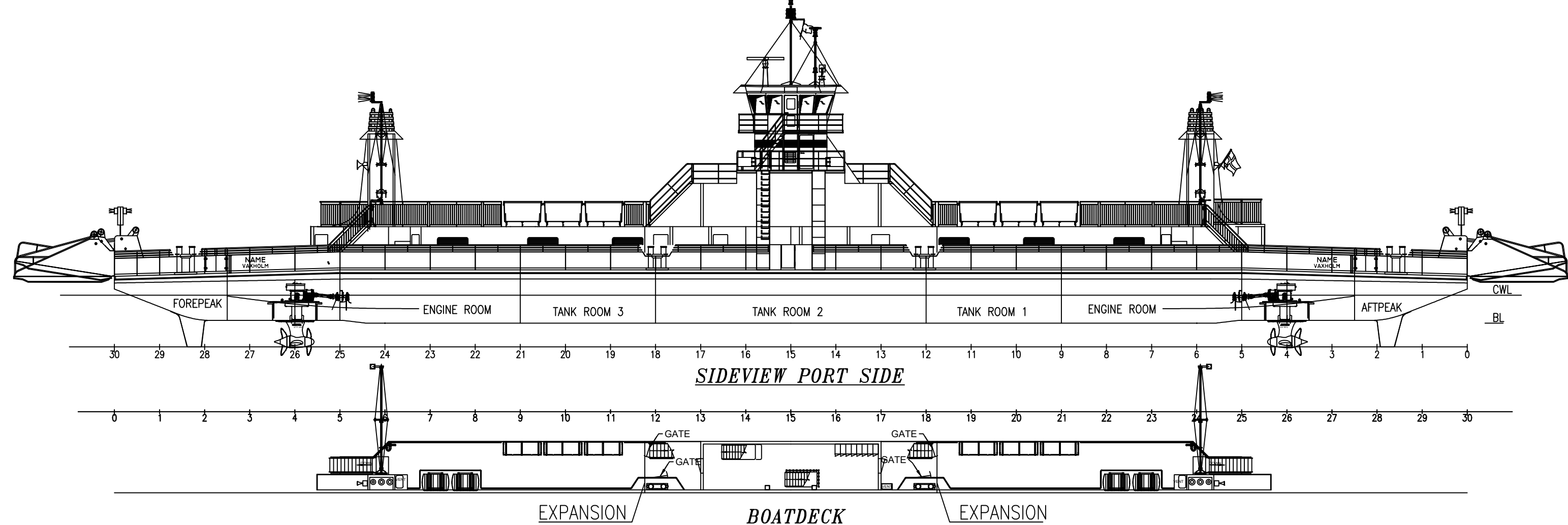
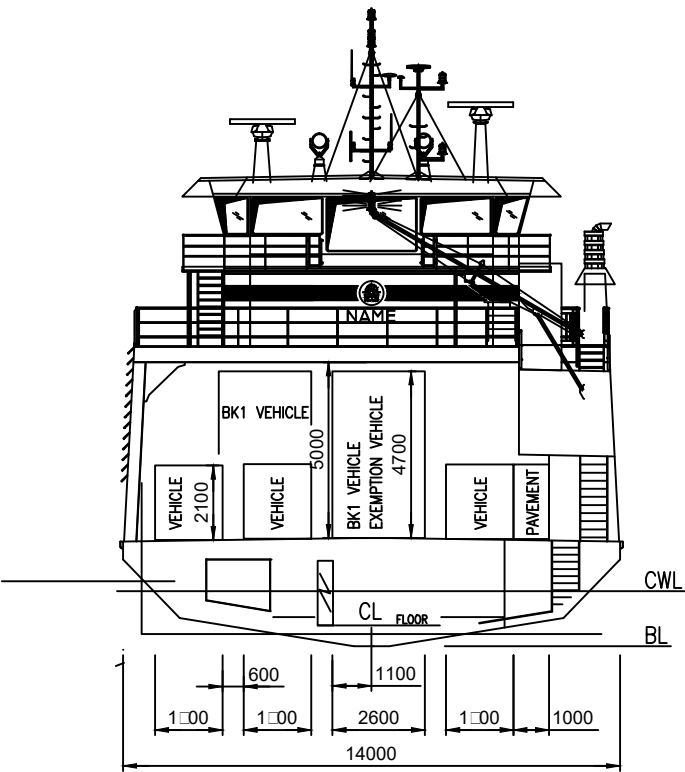
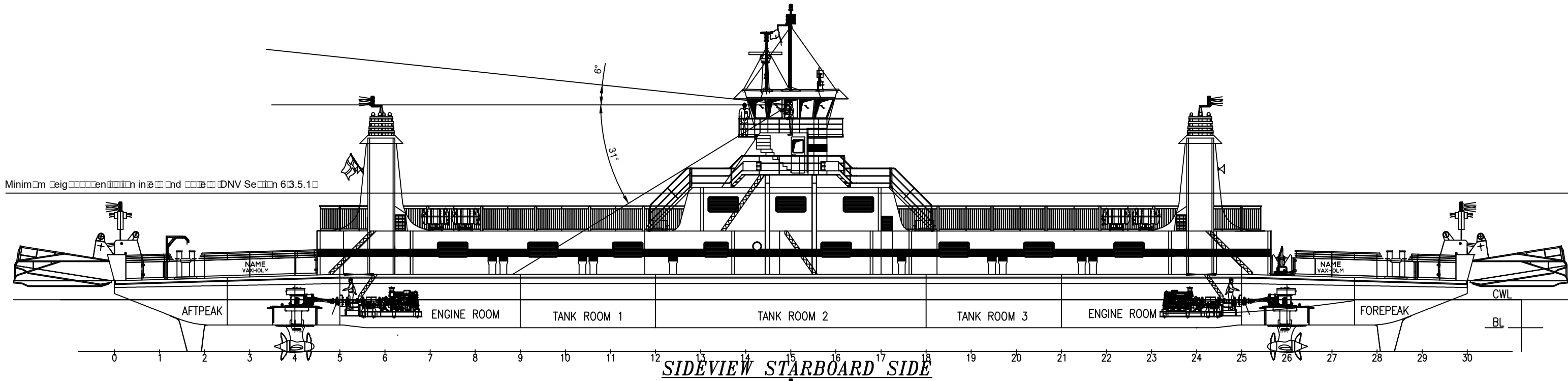

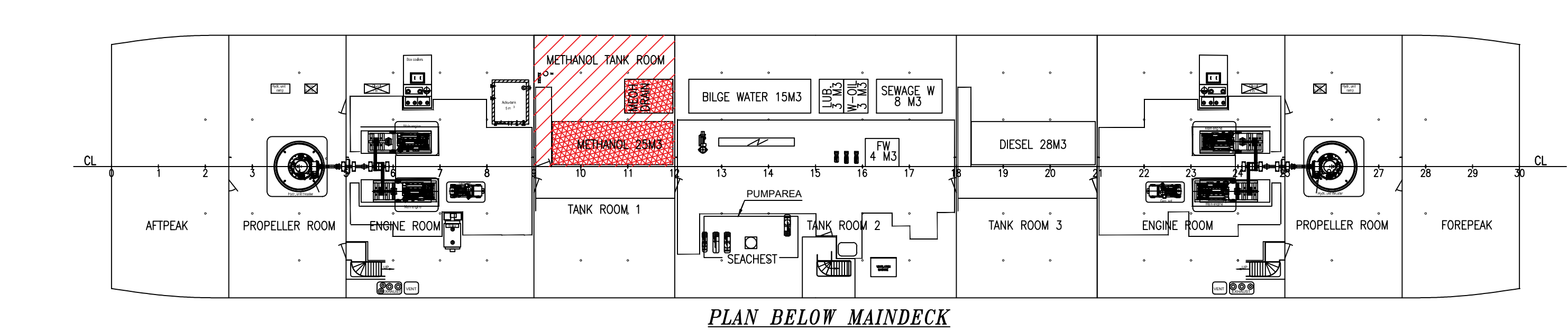
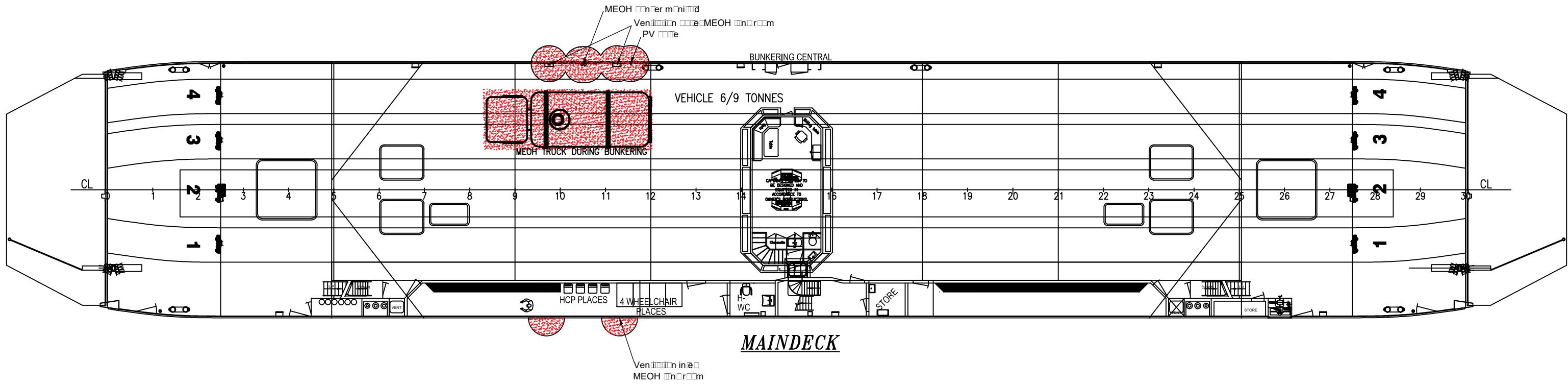
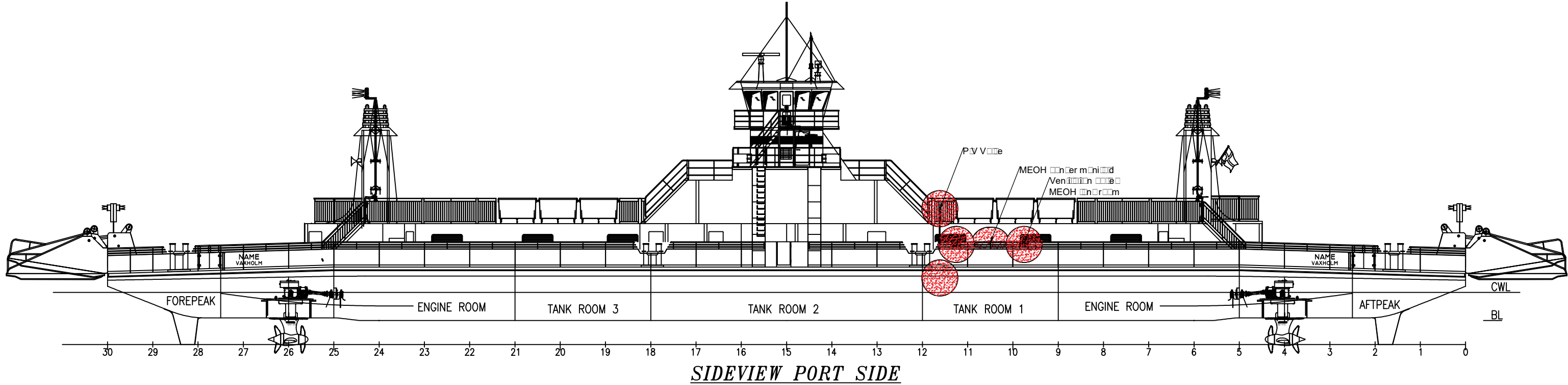
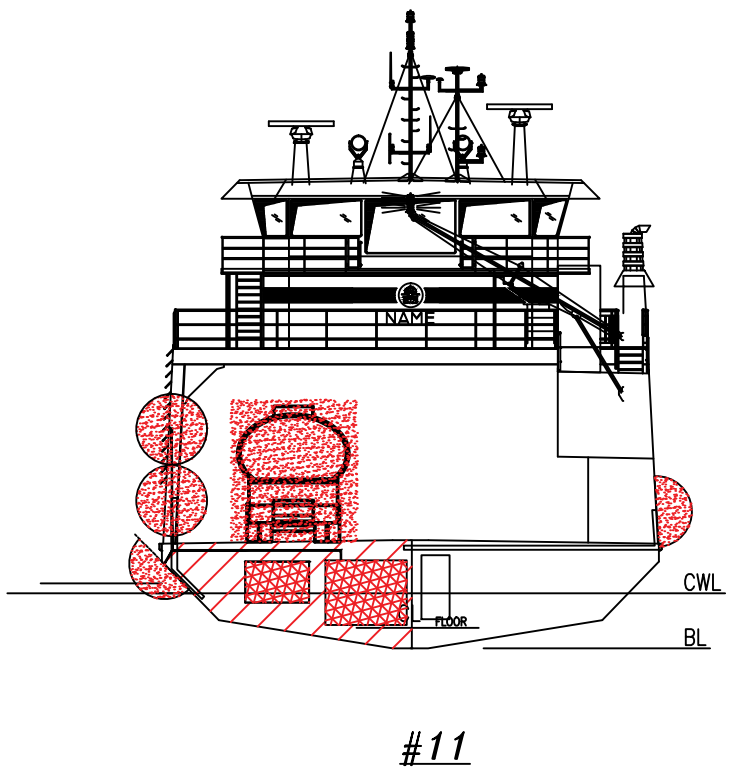
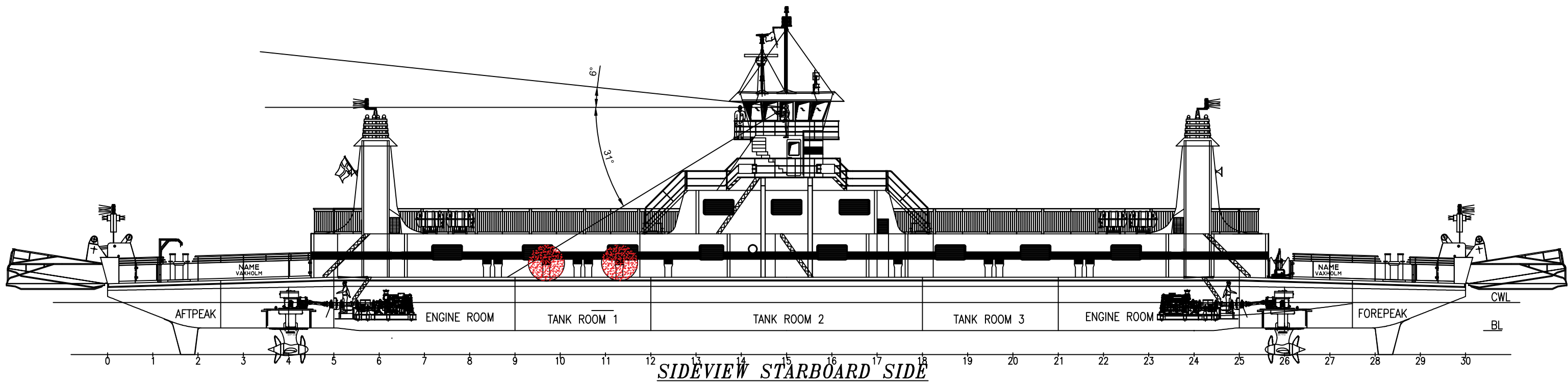

- HAZARDOUS AREA ZONE 0
- HAZARDOUS AREA ZONE 1
- HAZARDOUS AREA ZONE 2

Definitions  
Ref: DNV GL Rules for ships Part 6 - Additional Class notations

Zone 0  
Area in which an explosive gas atmosphere is present continuously or is present for long periods.

Zone 1  
Area in which an explosive gas atmosphere is likely to occur in normal operation

Zone 2  
Are in which an explosive gas atmosphere is not lot likely to occur in normal operation and, if it does occur , is likely to do so only infrequently and whill exist for a short period only

Guidance note:  
The definition of hazardous area is only related to the risk of explosion. In this context, helth, safety and environmental issues, i.e. toxicity, is not considered.

MAIN DIMENSIONS

LENGTH OVER ALL	8620 m
LENGTH OF HULL	75 m
LENGTH CWL	7327 m
BREADTH MOULDED	14 m
BREADTH INCL. FENDER	1416 m
BREADTH CWL	1226 m
DEPTH MOULDED	215 m
DRAUGHT CWL	155 m
DISPLACEMENT CWL	856 t
FRAME DISTANCE	2500 mm
NUMBER OF PASSENGER	37

APPENDIX IV - SNP15095-780 SYSTEM COORDINATION DIAGRAM

ISSUE	DESCRIPTION	DATE	DRWN	DATE	CHKD
0					

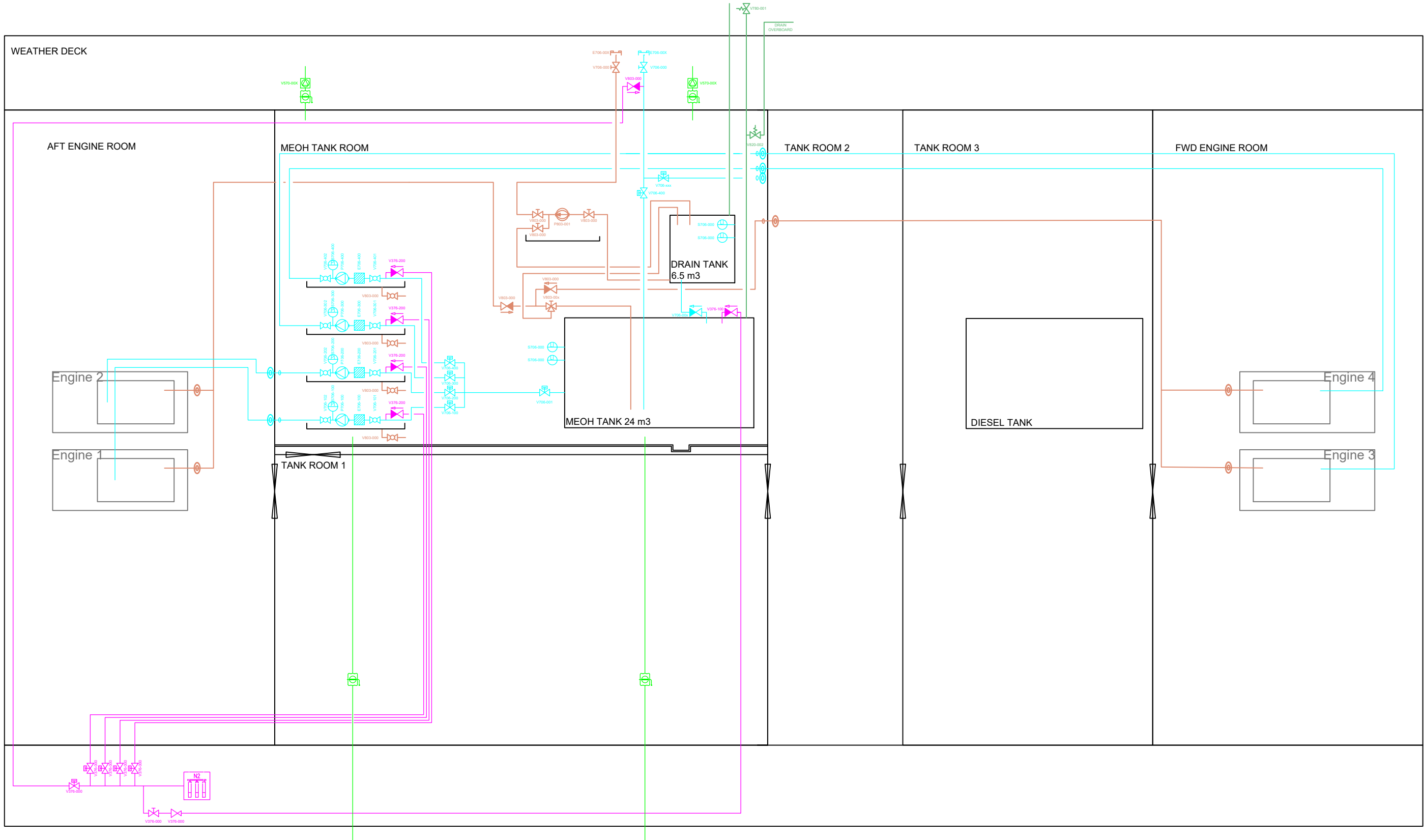

- METHANOL FUEL SYSTEM
- METHANOL DRAIN SYSTEM
- NITROGEN SYSTEM
- TANK VENTILATION AND OVERFLOW
- VENTILATION



ScandiNAOS AB

Adolf Edelsvårds gata 11 7  
414 41 Göteborg  
Sweden  
Phone +46 31 684381  
e-mail info@scandinaos.com  
web site www.scandinaos.com

Issuing for projects  
ScandiNAOS AB is not  
responsible for the  
accuracy of this drawing.  
The drawing must not be  
published, copied,  
reproduced, manufactured or  
exploited in any other way  
without the permission of  
ScandiNAOS AB.

Project number  
SNP15095

OWNER  
FÄRJEREDERIET

Class  
—

PREP. BY  
JB

CHECK. BY  
—

SCALE  
NTS

Sheet  
12

Shkls  
1 of 1

DATE  
2016-02-11

DATE  
—

DRINK 1/1  
SNP15095-780

JUPITER  
METHANOL CONVERSION  
SYSTEM COORDINATION DIAGRAM